

## Trailer Axles

Manutec carries a large range of ready made standard axles in 39mm, 40mm, 45mm and 50mm material.

Axles can be made to order in any size up to 110mm round.

Manutec has 2 options when ordering axles.

**Option 1:** Stock axles - imported steel. Measurement tip to tip is in inches.

**Option 2:** Special axles - made to order (Overlay/Drop/Spigot/Hollow Bar).

Axles can be ordered as loose components or as fully assembled ready to fit to the chassis.

Axles are available in the following standard cross sections.

39mm Round (Stock & Made to order)

40mm Square (Stock & Made to order)

45mm Square (Stock & Made to order)

50mm Square (Stock & Made to order)

63mm Square (Made to order)

## Stock Axles

Item Code Range	Profile	Bearings	Load Rating	Length (Tip to Tip)
M39RA65-39RA98	39mm Round	MLMA	1000kg	65" - 98"
M40SA65-M40SA98	40mm Square	MLMA	1000kg	65" - 98"
M45SB65-M45SB98	45mm Square	MLMB	1450kg	65" - 98"
M50SP65-M50SP98	50mm Square	MLMP	1600kg	65" - 98"
M50S2T65-M50S2T98	50mm Square	MLMA	2000kg	65" - 98"
M63S2.25T65-M63S2.25T98	63mm Square	MLME-2.25T	2250kg	65" - 98"
M63S3T65-M63S3T98	63mm Square	MLMF	3000kg	65" - 98"

Contact us for custom sizing.

## Stock Stub Axles

Item Code	Material	Bearings to suit	Load Rating	Length (Tip to Tip)
M39R8A	39mm Round	MLMA	500kg	8"
M39R10A	39mm Round	MLMA	500kg	10"
M39R12A	39mm Round	MLMA	500kg	12"
M40S8A	40mm Square	MLMA	500kg	8"
M40S9A	40mm Square	MLMA	500kg	9"
M40S10A	40mm Square	MLMA	500kg	10"
M40S12A	40mm Square	MLMA	500kg	12"
M45S9B-SPIGOT	45mm Square	MLMB	725kg	9"
M45S10B	45mm Square	MLMB	725kg	10"
M45S12B	45mm Square	MLMB	725kg	12"
M45R12B	45mm Round	MLMB	725kg	12"
M50S12B	50mm Square	MLMB	725kg	12"
M50S12P	50mm Square	MLMP	800kg	12"
M50S122TD	50mm Square	MLME	1000kg	12"
M65R163T	65mm Round	MLMF	1500kg	16"



### Stub Axles - Made to Order

Stub Axles can be made to order up to a maximum steel cross section of 110mm round. For machining profiles either an accurate drawing or sample is required.

### Axles and Stub Machining Profiles

A type bearing (MLMA)

A = 31.75mm  
B = 3/4" nut  
C = 19mm  
D = 37.5mm

B type bearing (MLMB)

A = 35mm  
B = 3/4" nut  
C = 22mm  
D = 44mm

Parallel Bearing (MLMP)

A = 35mm  
B = 1" nut  
C = 35mm  
D = 44mm

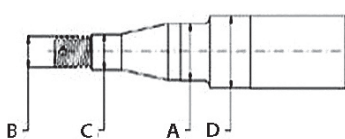

E type Dexter Style 2 tonne bearing (MLME)

A = 44.45mm  
B = 1" Nut  
C = 31.75mm  
D = 48mm

E type Alko Style 2.25/2.5 tonne bearing (MLME-2.25T)

A = 50mm  
B = 1" nut  
C = 31.75mm  
D = 60.3mm

F type bearing (MLMF)

A = 50mm  
B = 1 1/4" nut  
C = 38.1mm  
D = 60.3mm

F type Parallel (MLMF-P)

A = 45.45mm  
B = 1 1/4" nut  
C = 45.45mm  
D = 55.75mm

Composite (MLMC)

A = 31.75mm  
B = 3/4" nut  
C = 22mm  
D = 37.5mm

Manutec carries an extensive range of trailer hubs and braking components to suit most applications.

Standard trailer hubs include lazy hubs, disc hubs and hub drums, covering all common ratings and stud patterns.

We also stock a range of blank hubs that can be machined and studded to suit special applications or stud patterns.

Our braking components range includes calipers and backing plates to suit mechanical, hydraulic and electric braked trailers.

A complete range of hub and braking spare parts and components are also available.

Hubs and brakes can be purchased as individual parts or as fully assembled axles, ready to fit to a trailer.

Other non-standard hubs and braking parts can be sourced upon special request.

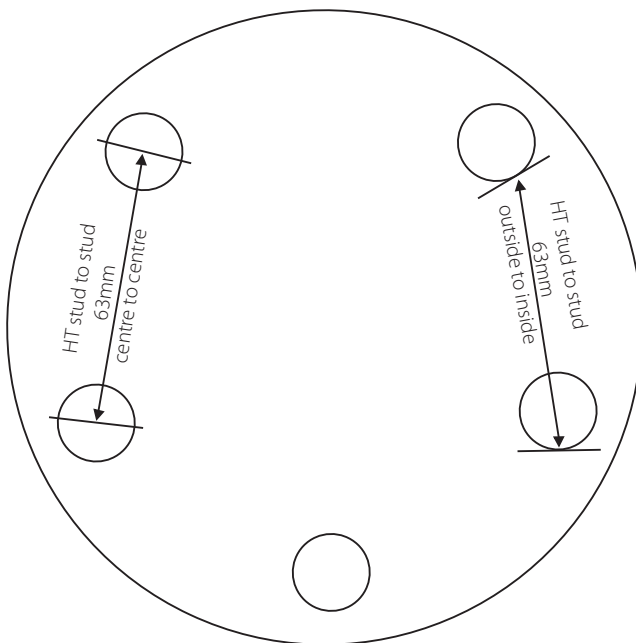

You can measure from centre to centre or from outside edge to inside edge to get PCD.

	STUD NUMBER	STUD TO STUD	PCD	
Mini	4	71mm	101.6mm	4"
Datsun	4	80mm	114.30mm	4 1/2"
HT	5	63mm	107.95mm	4 1/4"
HQ	5	71mm	120.65mm	4 3/4"
Commodore	5	70mm	120mm	
Ford	5	67mm	114.30mm	4 1/2"
TL5	5	88.5mm	150mm	
TL6	6	69mm	139.70mm	5 1/2"
F100	5	84mm	139.70mm	5 1/2"



**PCDCHECKGUN**

PCD gauge bolt pattern sliding measuring tool

# Lazy Hubs

## Datsun Hub

Item Code	PCD	Studs	Bearings	Features
MHD4A	114.3mm	4 x 7/16" UNF	MLMA	



## Mini Hub

Item Code	PCD	Studs	Bearings	Features
MMI4A	101.6mm	4 x 7/16" UNF	MLMA	150mm OD Flange
MMI4A(140)	101.6mm	4 x 7/16" UNF	MLMA	136mm OD Flange (Suits ATV Wheels)

## HT Pattern

Item Code	PCD	Studs	Bearings	Features
MHT5G	107.95mm	5 x 7/16" UNF	Not Supplied	Galvanised
MHT5A	107.95mm	5 x 7/16" UNF	MLMA	
MHT5A-J	107.95mm	5 x 7/16" UNF	MLMA-J	Premium Bearings
MHT5GA	107.95mm	5 x 7/16" UNF	MLMA	Galvanised
MHT5GN	107.95mm	5 x 7/16" UNF	Not Supplied	Grease Nipple
MHT5GNA	107.95mm	5 x 7/16" UNF	MLMA	Grease Nipple
MHT5GA-J	107.95mm	5 x 7/16" UNF	MLMA-J	Galvanised with Premium Bearings
MHT5B	107.95mm	5 x 7/16" UNF	MLMB	
MHT5GB	107.95mm	5 x 7/16" UNF	MLMB	Galvanised
MHT5GB-J	107.95mm	5 x 7/16" UNF	MLMB-J	Galvanised with Premium Bearings
MHT5B-J	107.95mm	5 x 7/16" UNF	MLMB-J	Premium Bearings



## HQ Pattern

Item Code	PCD	Studs	Bearings	Features
MHQ5	120.65mm	5 x 7/16" UNF	Not Supplied	No Bearings
MHQ5A	120.65mm	5 x 7/16" UNF	MLMA	
MHQ5A-J	120.65mm	5 x 7/16" UNF	MLMB-J	Premium Bearings
MHQ5B	120.65mm	5 x 7/16" UNF	MLMB	
MHQ5B-J	120.65mm	5 x 7/16" UNF	MLMB-J	Premium Bearings



## Commodore Pattern

Item Code	PCD	Studs	Bearings	Features
MHCD5	120mm	5 x 7/16" UNF	Not Supplied	No Bearings
MHCD5G	120mm	5 x 7/16" UNF	Not Supplied	Galvanised, No Bearings
MHCD5A	120mm	5 x 7/16" UNF	MLMA	
MHCD5A-J	120mm	5 x 7/16" UNF	MLMA-J	Premium Bearings
MHCD5GA	120mm	5 x 7/16" UNF	MLMA	Galvanised
MHCD5B	120mm	5 x 7/16" UNF	MLMB	
MHCD5B-J	120mm	5 x 7/16" UNF	MLMB-J	Premium Bearings
MHCD5GB	120mm	5 x 7/16" UNF	MLMB	Galvanised



**MLMA** = Holden / A Type / Standard / LM Bearings

**MLMA-J** = Holden / A Type / Standard / LM Premium Bearings

**MLMB** = Heavy Duty / Slim Line / Ford / B Type Bearings

**MLMB-J** = Heavy Duty / Slim Line / Ford / B Type Premium Bearings

# Lazy Hubs

## Ford Pattern

Item Code	PCD	Studs	Bearings	Features
MHF5	114.3mm	5 x 1/2" UNF	Not Supplied	No Bearings
MHF5G	114.3mm	5 x 1/2" UNF	Not Supplied	Galvanised, No Bearings
MHF5A	114.3mm	5 x 1/2" UNF	MLMA	
MHF5A-J	114.3mm	5 x 1/2" UNF	MLMA-J	Premium Bearings
MHF5GA	114.3mm	5 x 1/2" UNF	MLMA	Galvanised
MHF5GA-J	114.3mm	5 x 1/2" UNF	MLMA-J	Galvanised - Premium Bearings
MHF5B	114.3mm	5 x 1/2" UNF	MLMB	
MHF5B-J	114.3mm	5 x 1/2" UNF	MLMB-J	Premium Bearings
MHF5GB	114.3mm	5 x 1/2" UNF	MLMB	Galvanised
MHF5GB-J	114.3mm	5 x 1/2" UNF	MLMB-J	Galvanised - Premium Bearings
MHF5P-N	114.3mm	5 x 1/2" UNF	Not Supplied	Suits Parallel Bearings
MHF5P-N	114.3mm	5 x 1/2" UNF	Not Supplied	Suits Parallel Bearings



## Landcruiser Pattern (6 Stud, 6 x 139.7mm)

Item Code	PCD	Studs	Bearings	Features
MHTL6A-J	139.7mm	6 x 1/2" UNF	MLMA-J	Premium Bearings
MHTL6PG-N	139.7mm	6 x 1/2" UNF	Not Supplied	Galvanised - Parallel - No Bearings
MHTL6P-J	139.7mm	6 x 1/2" UNF	MLMP-J	Premium Bearings - Parallel
MHTL6PG	139.7mm	6 x 1/2" UNF	MLMP	Galvanised - Parallel
MHTL6PG-J	139.7mm	6 x 1/2" UNF	MLMP-J	Galvanised - Premium Bearings - Parallel
MHTL6	139.7mm	6 x 1/2" UNF	Not Supplied	No Bearings
MHTL6G	139.7mm	6 x 1/2" UNF	Not Supplied	Galvanised, No Bearings
MHTL6A	139.7mm	6 x 1/2" UNF	MLMA	
MHTL6GA	139.7mm	6 x 1/2" UNF	MLMA	Galvanised
MHTL6B	139.7mm	6 x 1/2" UNF	MLMB	
MHTL6B-J	139.7mm	6 x 1/2" UNF	MLMB-J	Premium Bearings
MHTL6GB	139.7mm	6 x 1/2" UNF	MLMB	Galvanised
MHTL6P	139.7mm	6 x 1/2" UNF	MLMP	Parallel
MHTL62T	139.7mm	6 x 1/2" UNF	Not Supplied	No Bearings - 2T Dexter Style
MHTL62TE	139.7mm	6 x 1/2" UNF	MLME	2 Tonne Bearings - Dexter Style
MHTL62TE-J	139.7mm	6 x 1/2" UNF	MLME-J	Premium 2 Tonne Bearings - Dexter Style
MHTL63T	139.7mm	6 x 1/2" UNF	Not Supplied	No Bearings - 3 Tonne
MHTL63TF	139.7mm	6 x 1/2" UNF	MLMF	3 Tonne Bearings
MHTL6TF-J	139.7mm	6 x 1/2" UNF	MLMF-J	Premium 3 Tonne Bearings

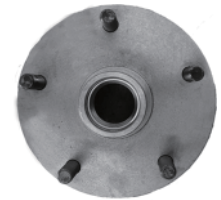

## Narrow HT Pattern (Agricultural Applications, Bearings Spaced Closer Together)

Item Code	PCD	Studs	Bearings	Features
MHI5G	107.95mm	5 x 7/16" UNF	Not Supplied	No Bearings - Galvanised - Grease Nipple
MHI5GA	107.95mm	5 x 7/16" UNF	MLMA	Galvanised - Grease Nipple

- MLMA** = Holden / A Type / Standard / LM Bearings
- MLMA-J** = Holden / A Type / Standard / LM Premium Bearings
- MLMB** = Heavy Duty / Slim Line / Ford / B Type Bearings
- MLMB-J** = Heavy Duty / Slim Line / Ford / B Type Premium Bearings
- MLMP** = Parallel Bearing Set
- MLMP-J** = Parallel Bearing Set - Premium Bearings
- MLME** = 2 Tonne Bearing Set (Dexter) Premium Bearings
- MLME-J** = 2 Tonne Bearing Set (Dexter) - Premium Bearings

- MLME-2.25T** = 2.25 Tonne Parallel Bearing Set
- MLME-2.25T-J** = 2.25 Tonne Parallel Bearing Set - Premium Bearings
- MLMF** = 3 Tonne Bearing Set
- MLMF-J** = 3 Tonne Bearing Set - Premium Bearings
- MLMP-3T** = 3 Tonne Parallel Bearing Set
- MLMP-3T-J** = 3 Tonne Parallel Bearing Set - Premium Bearings

# Lazy Hubs

## Landcruiser Pattern (5 Stud 5 x 150mm)

Item Code	PCD	Studs	Bearings	Features
MHTL5G	150mm	5 x 9/16" UNF	Not Supplied	Galvanised
MHTL5GA	150mm	5 x 9/16" UNF	MLMA	Galvanised
MHTL5GA-J	150mm	5 x 9/16" UNF	MLMA-J	Galvanised - Premium Bearings
MHTL5GB	150mm	5 x 9/16" UNF	MLMB	Galvanised
MHTL5GB-J	150mm	5 x 9/16" UNF	MLMB-J	Galvanised - Premium Bearings
MHTL5PG-N	150mm	5 x 9/16" UNF	Not Supplied	Galvanised - Parallel - No Bearings
MHTL5P	150mm	5 x 9/16" UNF	MLMP	Parallel Bearings
MHTL5PG-J	150mm	5 x 9/16" UNF	MLMP-J	Galvanised - Premium Bearings - Parallel
MHTL5P-N	150mm	5 x 9/16" UNF	Not Supplied	Parallel - No Bearings
MHTL5P-J	150mm	5 x 9/16" UNF	MLMP-J	Premium Bearings
MHTL5A(150)	150mm	5 x 9/16" UNF	MLMA	
MHTL5B-J(150)	150mm	5 x 9/16" UNF	MLMB-J	Premium Bearings
MHTL5A-J(150)	150mm	5 x 9/16" UNF	MLMA-J	Premium Bearings
MHTL5(150)	150mm	5 x 9/16" UNF	Not Supplied	No Bearings
MHTL5B(150)	150mm	5 x 9/16" UNF	MLMB	
MHTL53T	150mm	5 x 9/16" UNF	Not Supplied	3 Tonne - No Bearings

## Blank Lazy Hubs

Item Code	Description	Features
MH190BLANK	190mm Lazy Hub	Suits MLMA and MLMB

## Flangeless Hubs

Item Code	Bearings	Features
MFHA	MLMA	Weldable
MFHB	MLMB	Weldable

- MLMA** = Holden / A Type / Standard / LM Bearings
- MLMA-J** = Holden / A Type / Standard / LM Premium Bearings
- MLMB** = Heavy Duty / Slim Line / Ford / B Type Bearings
- MLMB-J** = Heavy Duty / Slim Line / Ford / B Type Premium Bearings
- MLMP** = Parallel Bearing Set
- MLMP-J** = Parallel Bearing Set - Premium Bearings
- MLME** = 2 Tonne Bearing Set (Dexter) Premium Bearings
- MLME-J** = 2 Tonne Bearing Set (Dexter) - Premium Bearings
- MLME-2.25T** = 2.25 Tonne Parallel Bearing Set
- MLME-2.25T-J** = 2.25 Tonne Parallel Bearing Set - Premium Bearings
- MLMF** = 3 Tonne Bearing Set
- MLMF-J** = 3 Tonne Bearing Set - Premium Bearings
- MLMP-3T** = 3 Tonne Parallel Bearing Set
- MLMP-3T-J** = 3 Tonne Parallel Bearing Set - Premium Bearings

## Custom

For custom stud patterns on Lazy Hubs, Please call for information.

# Hub Drums

## Hub Drums 9"

Item Code	Pattern	PCD	Studs	Bearing	Features
MHD9HT5	HT	107.95mm	5 x 7/16" UNF	Not Supplied	No Bearings
MHD9HT5A	HT	107.95mm	5 x 7/16" UNF	MLMA	
MHD9HT5B	HT	107.95mm	5 x 7/16" UNF	MLMB	
MHD9HT5A-J	HT	107.95mm	5 x 7/16" UNF	MLMA-J	Premium Bearings
MHD9HT5B-J	HT	107.95mm	5 x 7/16" UNF	MLMB-J	Premium Bearings
MHD9F5	Ford	114.3mm	5 x 1/2" UNF	Not Supplied	No Bearings
MHD9F5B	Ford	114.3mm	5 x 1/2" UNF	MLMB	
MHD9F5A	Ford	114.3mm	5 x 1/2" UNF	MLMA	
MHD9F5A-J	Ford	114.3mm	5 x 1/2" UNF	MLMA-J	Premium Bearings
MHD9F5B-J	Ford	114.3mm	5 x 1/2" UNF	MLMB-J	Premium Bearings
MHD9CD5	Commodore	120mm	5 x 7/16" UNF	Not Supplied	No Bearings
MHD9HQ5	HQ	120.65mm	5 x 7/16" UNF	Not Supplied	No Bearings
MHD9HQ5A	HQ	120.65mm	5 x 7/16" UNF	MLMA	
MHD9HQ5B	HQ	120.65mm	5 x 7/16" UNF	MLMB	
MHD9HQ5A-J	HQ	120.65mm	5 x 7/16" UNF	MLMA-J	Premium Bearings
MHD9HQ5B-J	HQ	120.65mm	5 x 7/16" UNF	MLMB-J	Premium Bearings
MHD9TL6A	Land Cruiser	139.7mm	6 x 1/2" UNF	MLMA	
MHD9TL6A-J	Land Cruiser	139.7mm	6 x 1/2" UNF	MLMA-J	Premium Bearings
MHD9TL6B-J	Land Cruiser	139.7mm	6 x 1/2" UNF	MLMB-J	Premium Bearings
MHD9TL6B	Land Cruiser	139.7mm	6 x 1/2" UNF	MLMB	
MHD9TL6-P	Land Cruiser	139.7mm	6 x 1/2" UNF	MLMP	Parallel Bearings
MHD9TL6	Land Cruiser	139.7mm	6 x 1/2" UNF	Not Supplied	No Bearings
MHD9TL5A	Land Cruiser	150mm	5 x 9/16" UNF	MLMA	
MHD9TL5B	Land Cruiser	150mm	5 x 9/16" UNF	MLMB	
MHD9TL5A-J	Land Cruiser	150mm	5 x 9/16" UNF	MLMA-J	Premium Bearings
MHD9TL5B-J	Land Cruiser	150mm	5 x 9/16" UNF	MLMB-J	Premium Bearings
MHD9TL5	Land Cruiser	150mm	5 x 9/16" UNF	Not Supplied	No Bearings

# Hub Drums

## Hub Drums 10"

Item Code	Pattern	PCD	Studs	Bearing	Features
MHD10F5	Ford	114.3mm	5 x 1/2" UNF	Not Supplied	No Bearings
MHD10F5A	Ford	114.3mm	5 x 1/2" UNF	MLMA	
MHD10F5B	Ford	114.3mm	5 x 1/2" UNF	MLMB	
MHD10F5-PC	Ford	114.3mm	5 x 1/2" UNF	MLMP	Parallel
MHD10F5-P	Ford	114.3mm	5 x 1/2" UNF	Not Supplied	Suits Parallel
MHD10CD5	Commodore	120mm	5 x 7/16" UNF	Not Supplied	No Bearings
MHD10HQ5	HQ	120.5mm	5 x 7/16" UNF	Not Supplied	No Bearings
MHD10TL6A	Land Cruiser	139.7mm	6x 1/2" UNF	MLMA	
MHD10TL6A-J	Land Cruiser	139.7mm	6x 1/2" UNF	MLMA-J	Premium Bearings
MHD10TL6B	Land Cruiser	139.7mm	6x 1/2" UNF	MLMB	
MHD10TL6B-J	Land Cruiser	139.7mm	6x 1/2" UNF	MLMB-J	Premium Bearings
MHD10TL6	Land Cruiser	139.7mm	6 x 1/2" UNF	Not Supplied	
MHD10TL6-P-C	Land Cruiser	139.7mm	6 x 1/2" UNF	MLMP	Parallel
MHD10TL6-P-NB	Land Cruiser	139.7mm	6 x 1/2" UNF	Not Supplied	Suits Parallel Bearings
MHD10TL5A	Land Cruiser	150mm	5 x 9/16" UNF	MLMA	
MHD10TL5B	Land Cruiser	150mm	5 x 9/16" UNF	MLMB	
MHD10TL5A-J	Land Cruiser	150mm	5 x 9/16" UNF	MLMA-J	Premium Bearings
MHD10TL5B-J	Land Cruiser	150mm	5 x 9/16" UNF	MLMB-J	Premium Bearings
MHD10TL5	Land Cruiser	150mm	5 x 9/16" UNF	Not Supplied	
MHD10TL5-P	Land Cruiser	150mm	5 x 9/16" UNF	MLMP	Parallel
MHD10TL5-PN	Land Cruiser	150mm	5 x 9/16" UNF	Not Supplied	No Bearings
MHD10BLANK	Machined to order				



## Hub Drums 12"

Item Code	Pattern	PCD	Studs	Bearing	Features
MHD12TL6-2T	Land Cruiser	139.7mm	6 x 1/2" UNF	Not Supplied	No Bearings, Suits Dexter
MHD12TL6-2TE-C	Land Cruiser	139.7mm	6 x 1/2" UNF	MLME	2 Tonne - Dexter Style
MHD12TL6-2.25TALKO	Land Cruiser	139.7mm	6 x 1/2" UNF	MLME-2.25T	2.25 T (50mm SQ)
MHD12TL6-2.5TALKO	Land Cruiser	139.7mm	6 x 1/2" UNF	MLME-2.5T	2.5 T (63mm SQ)
MHD12TL6-3T	Land Cruiser	139.7mm	6 x 1/2" UNF	MLMF	No Bearings
MHD12TL6-3TP-COMP	Land Cruiser	139.7mm	6 x 1/2" UNF	MLMF-P	3T Parallel
MHD12TL6-3TP-NB	Land Cruiser	139.7mm	6 x 1/2" UNF	Not Supplied	No Bearings, Suits 3T Parallel
MHD12TL5-2T	Land Cruiser	150mm	5 x 9/16" UNF	Not Supplied	No Bearings, Suits Dexter
MHD12TL5-2TE	Land Cruiser	150mm	5 x 9/16" UNF	MLME	2 Tonne - Dexter Style
MHD12TL5-3T	Land Cruiser	150mm	5 x 9/16" UNF	Not Supplied	No Bearings, Suits 3T
MHD12BLANK-A	Machined to order, Suits ALKO				
MHD12BLANK-D	Machined to order, Suits Dexter				
MHD12BLANK-3T	Machined to order, Suits 3T				

## Custom 10" & 12" Hub Drums

Custom stud patterns are available in both 10" & 12" Hub Drums. Please call for information.



# Disc Hubs

## Hub Disc 10"

Item Code	Pattern	PCD	Studs	Bearings	Features
MDH10MI4AG	MINI	101.6mm	4 x 7/16" UNF	MLMA	Beehive - Galv
MDH10HT5AG	HT	107.95mm	5 x 7/16" UNF	MLMA	Beehive - Galv
MDHHT5G	HT	107.95mm	5 x 7/16" UNF	Not Supplied	Galvanised
MDHHT5AG	HT	107.95mm	5 x 7/16" UNF	MLMA	Galvanised
MDHHT5BG	HT	107.95mm	5 x 7/16" UNF	MLMB	Galvanised
MDHHT5AG-J	HT	107.95mm	5 x 7/16" UNF	MLMA-J	Galvanised - Premium Bearings
MDHHT5BG-J	HT	107.95mm	5 x 7/16" UNF	MLMB-J	Galvanised - Premium Bearings
MDHF5	Ford	114.3mm	5 x 1/2" UNF	Not Supplied	Painted
MDHF5A	Ford	114.3mm	5 x 1/2" UNF	MLMA	Painted
MDHF5B	Ford	114.3mm	5 x 1/2" UNF	MLMB	Painted
MDHF5G	Ford	114.3mm	5 x 1/2" UNF	Not Supplied	Galvanised
MDHF5AG	Ford	114.3mm	5 x 1/2" UNF	MLMA	Galvanised
MDHF5BG	Ford	114.3mm	5 x 1/2" UNF	MLMB	Galvanised
MDHF5BG-J	Ford	114.3mm	5 x 1/2" UNF	MLMB-J	Galvanised - Premium Bearings
MDHF5AG-J	Ford	114.3mm	5 x 1/2" UNF	MLMA-J	Galvanised - Premium Bearings
MDHF5PG	Ford	114.3mm	5 x 1/2" UNF	MLMP	Galvanised - Parallel
MDHCD5G	Commodore	120mm	5 x 7/16" UNF	Not Supplied	Galvanised
MDHCD5AG	Commodore	120mm	5 x 7/16" UNF	MLMA	Galvanised
MDHCD5BG	Commodore	120mm	5 x 7/16" UNF	MLMB	Galvanised
MDHHQ5AG	HQ	120.65mm	5 x 7/16" UNF	MLMA	Galvanised
MDHHQ5BG	HQ	120.65mm	5 x 7/16" UNF	MLMB	Galvanised
MDHHQ5G	HQ	120.65mm	5 x 7/16" UNF	Not Supplied	Galvanised / Dacromet
MDHHQ5AG-J	HQ	120.65mm	5 x 7/16" UNF	MLMA-J	Galvanised - Premium Bearings
MDHHQ5BG-J	HQ	120.65mm	5 x 7/16" UNF	MLMA-J	Galvanised - Premium Bearings



## Hub Disc 11"

Item Code	Pattern	PCD	Studs	Bearings	Features
MDHTL6P-11	Land Cruiser	139.7mm	6 x 1/2" UNF	MLMP	
MDHTL6-2T-11	Land Cruiser	139.7mm	6 x 1/2" UNF	MLME	Dexter Bearings
MDHTL6-2T-ALKO	Land Cruiser	139.7mm	6 x 1/2" UNF	MLME-2.25T	2.25T (50mm SQ)
MDHTL6-2T-ALKO	Land Cruiser	139.7mm	6 x 1/2" UNF	MLME-2.25T	2.5T (63mm SQ)



## Hub Disc 12"

Item Code	Pattern	PCD	Studs	Bearings	Features
MDHTL6B	Land Cruiser	139.7mm	6 x 1/2" UNF	MLMB	
MDHTL6BG	Land Cruiser	139.7mm	6 x 1/2" UNF	MLMB	Galvanised
MDHTL6BZ	Land Cruiser	139.7mm	6 x 1/2" UNF	MLMB	Zinc
MDHTL6P	Land Cruiser	139.7mm	6 x 1/2" UNF	MLMP	Parallel
MDHTL6-3T	Land Cruiser	139.7mm	6 x 1/2" UNF	MLMF	3T Hub and Ventilated Rotor
MDHTL6-2T	Land Cruiser	139.7mm	6 x 1/2" UNF	MLME	Suits 2 T - Dexter Style
MDHTL5B	Land Cruiser	150mm	5 x 9/16" UNF	MLMB	
MDHTL5P	Land Cruiser	150mm	5 x 9/16" UNF	MLMP	Parallel
MDHTL5-2T	Land Cruiser	150mm	5 x 9/16" UNF	MLME	Dexter Bearings
MDHTL5-2TG	Land Cruiser	150mm	5 x 9/16" UNF	MLME	Galvanised - Dexter Bearings

## Spare parts - Bearings

Item Code	Description	A	B	C	D
MLMA	A Type Bearing Set (Chinese)	LM11949	LM67048	LM11910	LM67010
MLMA-OEM	A Type Bearing Set (Chinese - OEM)	LM11949	LM67048	LM11910	LM67010
MLMA-J	A Type Bearing Set (Premium)	LM11949	LM67048	LM11910	LM67010
MLMB	B Type Bearing Set (Chinese)	LM12749	L68149	LM12710	L68110
MLMB-OEM	B Type Bearing Set (Chinese - OEM)	LM12749	L68149	LM12710	L68110
MLMB-J	B Type Bearing Set (Premium)	LM12749	L68149	LM12710	L68110
MLMC-J	Composite Bearing Set (Premium)	LM12749	LM67048	LM12710	LM67010
MLMP	Parallel Bearing set (Chinese)	L68149	L68149	L68110	L68110
MLMP-OEM	Parallel Bearing set (Chinese - OEM)	L68149	L68149	L68110	L68110
MLMP-J	Parallel Bearing set (Premium)	L68149	L68149	L68110	L68110
MLME	2 tonne Dexter Bearing set (Chinese)	15123	25580	15245	25520
MLME-J	2 tonne Dexter Bearing set (Premium)	15123	25580	15245	25520
MLME-2.25T	2.25 tonne Bearing set	15123	30210	15245	
MLME-2.25TJ	2.25 tonne Bearing set (Premium)	15123	30210	15245	
MLMF	3 tonne Bearing set (Chinese)	LM29749	30210JR	LM29710	30210J
MLMF-J	3 tonne Bearing set (Premium)	LM29749	30210JR	LM29710	30210J
MLMP-3TJ	3 tonne Parallel Bearing set (Premium)	25590	25590	25520	25520
MLMP-3T-80	3 tonne Parallel Bearing set	25580	25580	25520	25520
MLMP-3T-90	3 tonne Parallel Bearing set	25590	25590	25520	25520
MLMP-J-3T-80	3 tonne Parallel Bearing set (Premium)	25580	25580	25520	25520
MLMP-J-3T-90	3 tonne Parallel Bearing set (Premium)	25590	25590	25520	25520

A = Outer Bearing  
B = Inner Bearing  
C = Outer Cup  
D = Inner Cup



## Spare parts - Seals

Item Code	Description	ID	OD
MSA	Holden, A type standard seal	37.50mm	59.10mm
MSAR	Holden, A type seal with spring	37.50mm	59.10mm
MSAWP	Holden, A type waterproof seal	37.50mm	59.10mm
MSB	Ford, B type standard seal	43.90mm	59.10mm
MSBWP	Ford, B type waterproof seal	43.90mm	59.10mm
MSE	2 tonne E type seal (Dexter)	48.00mm	85.90mm
MSEWP	2 tonne waterproof seal (Dexter)	48.00mm	85.90mm
MSF-S	3 tonne F type seal (Steel Outer)	60.30mm	89.96mm
MSF	3 tonne F type seal (Nylon Outer)	60.30mm	89.96mm
MSFWP	3 tonne F type waterproof seal (Nylon Outer)	60.30mm	89.96mm
MSF-P	3 tonne Parallel type seal	55.80mm	85.90mm
MSS	Seal Standard SIMPLICITY type - suit A74 A75L A75 - 3.000 x 1.875 x 0.375	47.60mm	76.20mm



# Grease Caps



45.2mm

**GRSCAP2**  
Standard Grease Cap



51mm

**GRSCAP2US**



63.6mm

**GRSCAP2.5**  
To suit 2 Tonne / Parallel Axle



62.2mm

**GRSCAP2.5US**  
Dexter



76.5mm

**GRSCAP3**  
To suit 3 Tonne Axle



90mm

**GRSCAP3.5**  
To suit 3 Tonne Parallel Axle

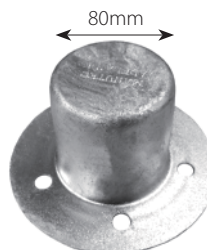

**PWOCAP/HT80**  
80mm Overcap  
5X107.95 PCD

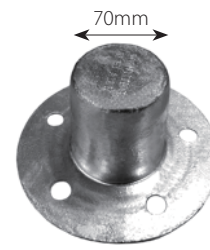

**PWOCAP/FORD70**  
70mm Overcap  
5X114.3 PCD

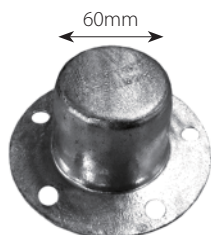

**PWOCAP/HT60**  
60mm Overcap  
5X107.95 PCD

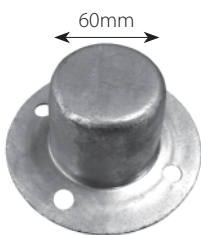

**PWOCAP/BMW60**  
60mm Overcap  
4X100mm PCD

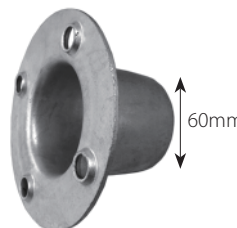

**PWOCAP/BMW60NR**  
60mm Overcap  
4X100mm PCD



**BEARBUD-BRA**  
Rubber Cover to suit  
2" Bearing Buddy  
Code is for 1 piece only



**BEARBUD2-CR**  
2" Bearing Buddy Chrome  
Code is for 1 piece only



**BEARBUD2-CRB**  
2" Bearing Buddy & Bra  
Chrome



**BEARBUD2-SS**  
2" Bearing Buddy  
Code is for 1 piece only  
Stainless Steel



**BEARBUD2-SSB**  
2" Bearing Buddy & Bra  
Stainless Steel



**PREMHDGREASE20KG**  
PREMIUM HD Grease  
- CASTROL  
- 20kg



**MP-ALKO-RING**  
Ring to convert parallel hubs  
to alko  
Insert inside cup of outer  
bearing in drum



**M2.25TLD-RING**  
Ring to suit alko 2.25 Id  
50 sq  
bar

# Spare parts - Nuts and Bolts



## NUT716/SW

Nut 7/16 inch with spring washer  
To suit mechanical and electric backing plates

## NUT3/8SW

Nut 3/8 inch with spring washer  
To suit hydraulic and electric backing plates



## BOLT716X1

Bolt 7/16 inch x 1 inch(UNF)  
To suit mechanical brake plate

## BOLT716X1-UNC

Bolt 7/16 inch x 1 inch(UNC)  
To suit mechanical brake plate



## PWHTSTUD55 PWHTSTUD85

(Extra long 7/16 studs)



## SPRINGWASHER12

1/2" Spring Washer

## SW3/8

3/8" Spring Washer

## SW7/16

7/16" Spring Washer



## Wheel Nut(UNF)

Item Code	Size
MWN716	7/16"
MWN12	1/2"
MWN916	9/16"
MWN58	5/8"



## Wheel Stud(UNF)

Item Code	Size
MWS716	7/16"
MWS12	1/2"
MWS916	9/16"
MWS58	5/8"
MWS12-63mm	1/2" x 63mm



## Castle Nut

Item Code	Size
CNUT1.0	1"
CNUT1.0-12TPI	1" - 12TPI
CNUT3/4	3/4"
CNUT1.25	1 1/4"
CNUT7/8	7/8"



## WASHER

Item Code	Size
WASHER1.0	1" Flat Washer
WASHER1 1/4	1 1/4" Flat Washer
WASHER3/4	3/4" Flat Washer
WASHER7/8	7/8" Flat Washer
WASHER3/8	3/8" Flat Washer
FWASHERM10	M10 Flat Washer



## 58NF8N

5/8" UNF Grade 8 Nut - Black

## NUT 3/8

3/8" Nut

## NUT 7/16

7/16" Nut



## BOLT38X2

Bolt 3/8 inch x 2 inch

## BOLT/NUT38X1

Bolt 3/8 inch x 1 inch Nut and Spring Washer To suit hydraulic and electric brake back plates

## Axle Nut, Pin & Washer

Item Code	Size
CNUT1.25-NPW	Nut, Pin & Washer
MAN34NPWSET	3/4" Axle Nut, Pin & Washer
MAN78NPWSET	7/8" Axle Nut, Pin & Washer
MAN1NPWSET	1" Axle Nut, Pin & Washer
MAN1/14NPWSET	1 1/4" Axle Nut, Pin & Washer

## SPLITPIN

Item Code	Size
SPLITPIN4X71	4mm x 71mm
SPLITPIN4X50	4mm x 50mm
SPLITPIN5X75	5mm x 75mm
SPLITPIN4X50HP	4mm x 50mm 10 pack
SPLITPIN5X75BP	5mm x 75mm 50 pack
SPLITPIN4X50BULK	4mm x 50mm 50 pack
SPLITPIN4X32BULK	4mm x 32mm 200 pack
SPLITPIN4X50BULK200	4mm x 50mm 200 pack



# Brake Caliper Parts - Hydraulic Disc



**HBCG-L**  
Hydraulic Caliper  
Assembly - Galv - Left



**HBCG-R**  
Hydraulic Caliper  
Assembly - Galv - Right



**HBCG-KIT**  
Hydraulic Caliper  
Assembly - Galv - Pair



**HBCG-A-L**  
Hydraulic - ALKO Style  
Caliper - Left



**HBCG-A-R**  
Hydraulic - ALKO Style  
Caliper - Right



**HBCG-A-KIT**  
Hydraulic - ALKO Style  
Caliper - Pair



**HBCG-3T-L**  
Heavy Duty Hydraulic  
Caliper - Left



**HBCG-3T-R**  
Heavy Duty Hydraulic  
Caliper - Right



**BH400**  
Flexible Brake Hose  
400mm long



**HBCG-PADS**  
Brake Caliper Pads (Pair)  
To suit HBCG-L / HBCG-R



**HBCG-A-PADS**  
Brake Caliper Pads (Pair)  
To suit HBCG-A-L / HBCG-A-R



**HBCGPADS-DEEMAXX**  
Brake Caliper Pads (Pair)  
To suit DEEMAXX style

# Brake Parts

## Magnets

Item Code	Description
OMC10	10" Oval Magnet with retaining clip to suit Dexter Design Back Plate EBPL10-D / EBPR10-D
OMC10-A	10" Oval Magnet with retaining clip to suit Alko Design Back Plate EBPL10-A / EBPR10-A
OMC10-OR-L	10" Oval Magnet with spring – left hand – off road
OMC10-OR-R	10" Oval Magnet with spring – right hand – off road
OMC10-SC	Spare spring and retaining clip for OMC10
OMC12	12" Oval Magnet with retaining clip to suit 12" Back Plate EBPL12 / EBPR12
OMC12-OR-L	12" Oval Magnet with spring – left hand – off road
OMC12-OR-R	12" Oval Magnet with spring – right hand – off road



## Brake Line

Item Code	Axle	Size
MSSFLK-SA	Single	Stainless Steel Braided Flexi-line Brake line set
MSSFLK-DA	Double	Stainless Steel Braided Flexi-line Brake Line Set
MRFLK-SA	Single	Flexi-line Rubber Brake Line Set
MRFLK-DA	Double	Flexi-line Rubber Brake Line Set



## Brake Tube

Item Code	Size
MCBT15	Copper Bundy Tube 15m Length 3/16 x 0.71x15m
MSBT20	Steel Bundy Tube (Brass Plated) 3/16x71mmx20m
MSBT100	Steel Bundy Tube (Brass Plated) 3/16x71mmx100m



## Braking

Item Code	Description
MHBWC	Hydraulic Cylinder to suit 9" HBP
MHBWC-10-L	Hydraulic Cylinder to suit 10" HBPL
MHBWC-10-R	Hydraulic Cylinder to suit 10" HBPR
MHBWC-12-L	Hydraulic Cylinder to suit 12" HBPL
MHBWC-12-R	Hydraulic Cylinder to suit 12" HBPR
MHBWC-12DP-L	Hydraulic Cylinder to suit 12" DP HBPL
MHBWC-12DP-R	Hydraulic Cylinder to suit 12" DP HBPR



**BLN**  
Brass Long Tube Nut



**BSN**  
Brass Standard Tube Nut



**BTWP**  
Brass 3 Way Piece



**BNJOIN**  
Brass Standard Join Nut



**MBHBRKT**  
Flexible Brake Hose Bracket  
bolt on - Flexible Brake Hose  
CLIP



**HBRAKEASS**  
Hand Brake Assembly  
Quick Release Ratchet Style



**MSSBC10**  
Brake Cable Stainless  
Steel 10m Length



**BHU38TP124**  
Brass Hydraulic Union  
3/8" 24TPI



**MBHCLIP**



**MCW38**  
3/8" Copper Washer

# Brake Parts - Brake Shoes



**SS9**  
9" Spare Shoes



**SS10-ALKO**  
10" Spare Shoes - ALKO style



**SS10-DEXTER**  
10" Spare Shoes - Dexter style



**SS10-SA-LEFT**  
10" Spare Shoes - Left  
Self Adjusting Type



**SS10-SA-RIGHT**  
10" Spare Shoes - Right  
Self Adjusting Type



**SS10-SA-K**  
10" Spare Shoes - Kit (Pair)  
Self Adjusting Type



**SS12-A**  
12" Spare Shoes - ALKO style



**SS12-D**  
12" Spare Shoes - Dexter style



**SS12-SA-LEFT**  
12" Spare Shoes - Left  
Self Adjusting Type



**SS12-SA-RIGHT**  
12" Spare Shoes - Right  
Self Adjusting Type



**SS12-SA-K**  
12" Spare Shoes - Kit (Pair)  
Self Adjusting Type

## Weld on Parts



### MMPS40S

Square Mounting Plate.  
40mm Square  
To suit electric back plate and  
mechanical back plate.  
Also available round: MMPS40R



### MMPS43.5R

Square Mounting Plate  
43.5mm Round



### MMPS45S

Square Mounting Plate.  
45mm Round  
To suit electric back plate and  
mechanical back plate.  
Also available square: MMPS45R



### MMPS50S

Square Mounting Plate  
50mm Square



### MMPO39

Mechanical Brake Caliper  
Mounting Plate. 39mm off  
centre type.



### MMPO40/MMPO45 /MMPO50

Mechanical Brake Caliper  
Mounting Plate.  
40mm/45mm/50mm SQ  
off centre type



### MMPO45-12

Mechanical Brake Caliper  
Mounting Plate 45mm  
12 inch Disc, Offset type



### MMPO50-12

Brake Caliper Mounting Plate  
50mm Square, 12 inch disc



### MMPR40S

Round Mounting Plate.  
40mm Square  
To suit hydraulic back plate.



### MMPR45R

Round Mounting Plate  
45mm Round  
To suit hydraulic back plate.



### MMPS50S-12

Mounting Plate  
50mm 12 inch drum



### MMPS65R-12

Mounting Plate  
To suit hydraulic calipers 12 inch



### MMPH45-10

Brake Caliper Mounting Plate  
To suit hydraulic calipers  
45mm square



### MMPR45R

Brake Caliper Mounting Plate  
To suit hydraulic calipers  
50mm square



### M3DROP

3" Drop Plate  
To suit 32mm spigot  
Also available M3DROP-HD  
to suit 40mm SPIGOT



### M4DROP

4" Drop Plate  
to suit Spigot  
Also available M4DROP-HD  
to suit 40mm SPIGOT



### M50X3DP/M50X4DP

50mm Square 3"  
drop plate



### M45X3DP

45mm Square  
3" drop plate



### M45X4DP

45mm Square  
4" Drop Plate



# Brake Parts - Mechanical



**MBCG**  
Mechanical Brake Caliper  
Galvanised, with pads, slides & bolts



**MBCPADS**  
Mechanical Brake  
Spare Pads (Pair)



**MBCRK**  
Mechanical Brake  
Caliper Repair Kit



**SS9-M**  
9" Spare Shoes  
(Mechanical)



**BOLT716X1**  
Bolt 7/16 inch x 1 inch  
To suit mechanical brake plate mounting  
plate 45mm 2 inch Disc, Offset type



**NUT716/SW**  
Nut 7/16 inch with spring washer  
To suit mechanical and electrical  
backing plates



**BRKCABL-ADJ**  
Brake Cable Adjuster



**BRKCABL-ADJ-HD**  
Brake Cable Adjuster  
Heavy Duty



**BRKCABL-HDSET**  
Brake Cable Adjuster Set  
Heavy Duty



**MSSBC8/MSSBC10**  
Brake Cable Stainless Steel  
8m/10m length

Also available cut to length



## Wire Rope Grips

Item Code	Size
MWRG	5mm
MWRG6MM	6mm
MWRG8MM	8mm
MWRG10MM	10mm
MWRG12MM	12mm



**BRKCAB-P**  
Brake Cable Pulley

# Electric Brake Plates

## Dexter Style

Size	Item Code	Side
10"	EBPL10-D	Left
10"	EBPR10-D	Right
10"	EBPK10-D	Both
12"	EBPL12-D	Left
12"	EBPR12-D	Right
12"	EBPK12-D	Both



## Alko Style

Size	Item Code	Side
10"	EBPL10-A	Left
10"	EBPR10-A	Right
10"	EBPK10-A	Both
12"	EBPL12-A	Left
12"	EBPR12-A	Right
12"	EBPK12-A	Both



## Off Road

Size	Item Code	Side
10"	EBPL10-OR	Left
10"	EBPR10-OR	Right
10"	EBPK10-OR	Both
12"	EBPL12-OR	Left
12"	EBPR12-OR	Right
12"	EBPK12-OR	Both



# Hydraulic Brake Plates

## 9" Hydraulic Backing Plate

Item Code	Side
HBPL9	Left
HBPR9	Right
HBPK9	Both
HBPL9-C	Left + nuts
HBPR9-C	Right + nuts



## 10" Hydraulic Backing Plate

### Single Plunger Type

Item Code	Side
HBPL10	Left
HBPR10	Right
HBPK10	Both



## 12" Hydraulic Backing Plate

### Single Plunger Type

Item Code	Side
HBPL12	Left
HBPR12	Right
HBPK12	Both



### Double Plunger Type

Item Code	Side
HBPL12-DP	Left
HBPR12-DP	Right
HBPK12-DP	Both



# Brake Controllers



**MEBC-P**  
PRIMUS IQ Electric  
Brake Controller



**EBRH-ACCV3**  
Redarc Tow-Pro Elite V3 Electric Trailer  
Brake Controller 12/24V input up to 3  
Axles, Remote Switch Active Calibration



**MTMEBC-AME**  
Trailer Mount  
Electric Brake Controller



**MHA1200**  
Hydraulic Brake  
Actuator - 1200 PSI



**MHA1600**  
Hydraulic Brake  
Actuator - 1600 PSI



**MHA1200 - CAP**  
Suits - 1200/1600



**MBBRKAWAY**  
Brake Away System

Unit Weight 2.0kg



**MBS6000**  
6000 Brake Safe Kit

Unit Weight 2.9kg



**MCCBRKAWAY**  
Brake Away Coil Cable

Unit Weight 0.01kg



**MSWBRKAWAY**  
Brake Away Switch

Unit Weight 0.05kg

# Calculating Axle length

When determining axle length there are three measurements that can be used.

- Chassis Width (CW)
- Hub Face to Face (AFF)
- Axle Tip to Tip (ATT)

All Manutec axles are coded by their tip to tip measurement. Stock axles are calculated in inches and made to order axles made from Australian steel is in mm.

Additionally you should also know the wheel back space (BS), the width of the tyre (TW) that you are fitting to the rim and the clearance needed between tyre and chassis (TC). Mudguards for each wheel size are normally designed to allow a minimum TC of 45mm.

CW	Chassis Width Measurement
AFF	Hub Face To Face Measurement
ATT	Axle Tip To Tip Measurement
RS	Wheel Rim Rear Spacing
TW	Tyre Width
TC	Tyre Clearance To Chassis
ROS	Rim Offset
BS	Wheel Back Space
RW	Rim Width
HF	Hub Factor

Manutec can assist with the calculation of the correct axle length once the chassis and wheel dimension are known.

# Obtaining Measurements

To calculate Axle Tip To Tip measurement for an existing axle simply measure the axle from end to end to obtain the overall length.

If the axle has hubs assembled on the axle take a measurement from hub face to hub face then, using the table below, add the amount to give you a tip to tip measurement.

Hub	Axle Material	
Standard Hub	39mm Round	+110mm
Standard Hub	40mm Square	+110mm
Standard Hub	45mm Square	+110mm
Parallel Hub	45/50mm Square	+115mm
2 Tonne	50mm Square	+160mm
2.25 Tonne	50mm Square	+160mm
2.5 Tonne	63mm Square	+160mm
3 Tonne	63mm Square	+170mm
3 Tonne (Parallel)	63mm Square	+170mm

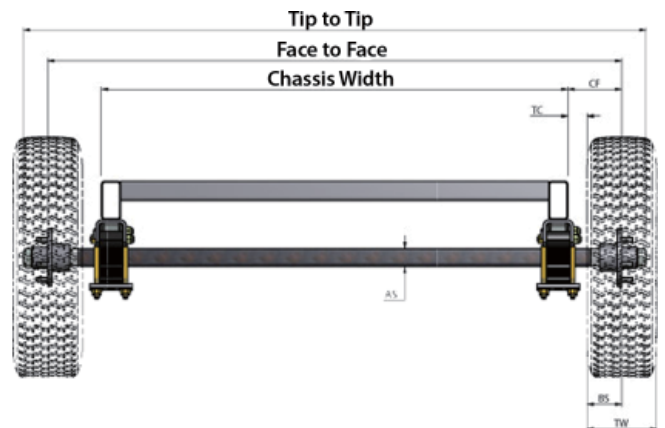
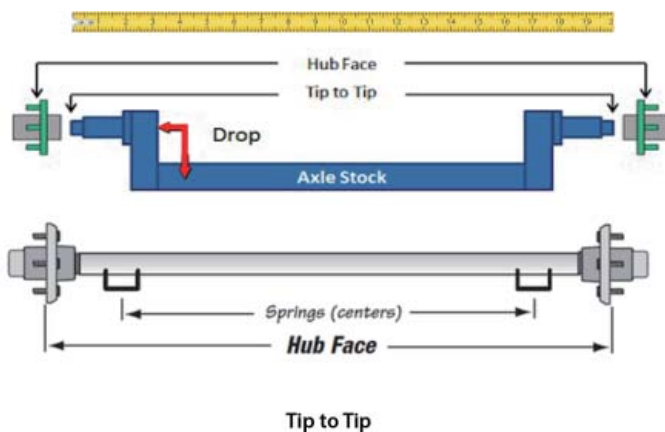

## Stock Axles

### 39mm Round Stock Axles (Load Capacity 1000kg)

All 39mm round stock axles are machined for A type (Holden) bearings.

Made To Order

M39RAXX

XX = Length (Tip to Tip) in inches



To convert length (Tip to Tip) to length (Face to Face)  
subtract 4.33" (110mm)

### 40mm Square Stock Axles (Load Capacity 1000kg)

All 40mm square stock axles are machined for A type (Holden) bearings.

Made To Order

M40SAXX

XX = Length (Tip to Tip) in inches



To convert length (Tip to Tip) to length (Face to Face)  
subtract 4.33" (110mm)

### 45mm Square Stock Axles (Load Capacity 1000kg- 1600kg)

45mm square stock axles are machined for B Type (Ford) or P Type (Parallel) bearings.

Made To Order

M45SBXX, M45SPXX

XX = Length (Tip to Tip) in inches



To convert length (Tip to Tip) to length (Face to Face)  
subtract 4.33" (110mm) for B Type and 4.52" (115mm) for P Type.

### 50mm Square Stock Axles (Load Capacity 1600kg- 2250kg)

50mm square stock axles are machined for either P Type (Parallel) or 2 Tonne and 2.25 Tonne bearings.

Made To Order

M50SPXX,

M50S2TXX (Dexter Style)

M50S2.25TXX (ALKO Style)

XX = Length (Tip to Tip) in inches



To convert length (Tip to Tip) to length (Face to Face)  
subtract 4.52" (115mm) for P type and 6.3" (160mm) for 2 Tonne and 2.25 Tonne.

# Made To Order Axles - Australian Steel

## 39mm Round Axles (Load Capacity 1000kg)

All 39mm round axles are machined for A type (Holden) bearings.

Made To Order  
M39RAXXXX-AU



To convert length (Tip to Tip) to length (Face to Face)  
subtract 4.33" (110mm)

## 40mm Square Axles (Load Capacity 1000kg)

All 40mm square axles are machined for A type (Holden) bearings.

Made To Order  
M40SAXXXX-AU



To convert length (Tip to Tip) to length (Face to Face)  
subtract 4.33" (110mm)

## 45mm Square Axles (Load Capacity 1000kg- 1600kg)

45mm square axles are machined for A type (Holden) bearings. B Type (Ford) or P Type (Parallel) bearings.

Made To Order  
M45SAXXXX-AU  
M45SBXXXX-AU, M45SPXXXX-AU,



To convert length (Tip to Tip) to length (Face to Face)  
subtract 4.33" (110mm) for A/B Bearings and 4.52" (115mm) for P Bearings.

## 50mm Square Axles (Load Capacity 1600kg- 2250kg)

50mm square axles are machined for either P Type (Parallel), 2 Tonne bearings (Dexter) or 2.25 Tonne bearings (ALKO).

Made To Order  
M50SPXXXX-AU,  
M50S2TXXXX-AU, M50S2.25TXXXX-AU



To convert length (Tip to Tip) to length (Face to Face)  
subtract 4.52" (115mm) for P type and 6.3" (160mm) for 2 Tonne Dexter and 2.25 Tonne ALKO.

## 63mm Square Axles (Load Capacity 2500kg & 3000kg)

All 63mm square axles are machined for 2.5 Tonne (ALKO), 3 Tonne or 3 Tonne Parallel Bearings.

Made To Order  
M63SQ3TPXXXX-AU,  
M63SQ3TXXXX-AU, M63SQ2.5TXXXX-AU



To convert length (Tip to Tip) to length (Face to Face)  
subtract 6.3" (160mm) for 2.5 Tonne and 6.69" (170mm) for 3 Tonne Parallel and standard 3 Tonne.

## Drop And Overlay Axles

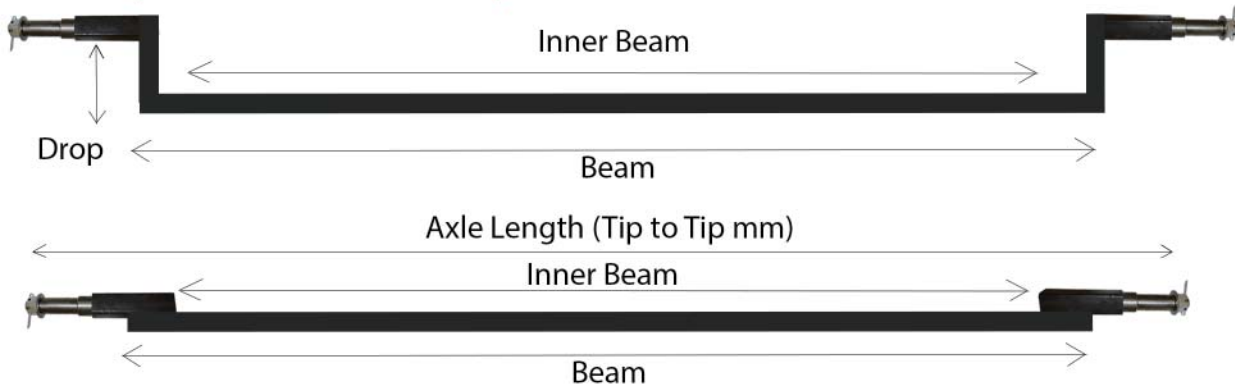

### Product Codes

Made To Order

MAN 

40
45
50

 S 

A
B
P

 XXXX-DRP 

2
3
4

XXXX = Length overall tip to tip

40 = 40mm SQ  
45 = 45mm SQ  
50 = 50mm SQ

A = HOLDEN BEARINGS  
B = FORD BEARINGS  
P = PARALLEL BEARINGS

2 = OVERLAY  
3 = 3" DROP  
4 = 4" DROP



## Obtaining Measurements

When there is no axle or for a new build, the length can be calculated using Chassis Width, the wheel rim rear spaces or back space.

CW - Chassis Width Measurement can be obtained by trailer design (new trailers) or by measuring from outside of chassis rail to outside of chassis rail.

RS - Wheel Rim Rear Spacing, this can be measured if you have the rim by placing a straight edge across the back of the rim and then measuring the distance to the wheel mounting surface.

**AFF - Axle Face To Face measurement is calculated using:**

$$AFF = CW + 2 TC + 2 BS$$

Example 1. Chassis Width (CW) 1524mm (5ft)

Tyre 185R14LT

ROS +14

$$AFF = 1524 + 2 \times 45 + 2 \times 106.5 = 1827\text{mm}$$

RW - Rim Width can be calculated by  $RS =$

Note: ROS can be positive or negative zero

$$RW/2 + ROS$$

BS - Wheel Back Space, if you have the wheel this can be measured as shown above, or to calculate this use the following formula:

$$BS = TW/2 + ROS$$

Example 1. 185R14LT tyre fitted to rim with positive 14 offset

$$= 185/2 + 14$$

$$= 106.5\text{mm}$$

Example 2. 235/75R15LT tyre fitted to rim with zero offset

$$= 235/2 + 0$$

$$= 117.5\text{mm}$$

### TO MEASURE YOUR WHEEL BACKSPACE:

PLACE THE WHEEL ON THE GROUND (FACE UP)

MEASURE FROM THE FLOOR TO WHERE THE WHEEL MEETS THE HUB FACE. (mm)



## Assembled Lazy Axles

### 39mm Round/40mm Square Axles

Bearings - A type (Holden)

Hubs - HT, HQ, Ford, Mini, Mini (140), Commodore, Datsun, Landcruiser  
(Other Hubs by special order)

Straight, Overlay, 3" Drop, 4" Drop.

Black and Galv



### 45mm Square Axles

Bearings - B type (Ford)  
- P type (Parallel)

Hubs - HT, HQ, Ford, Mini, Commodore, Datsun, Landcruiser  
(Other Hubs by special order)

Straight, Overlay, 3" Drop, 4" Drop.

Black and Galv



### 50mm Square Axles

Bearings - P type (Parallel)  
- 2 tonne (Dexter)  
- 2.25 tonne (ALKO)

Hubs - Ford, Landcruiser (5 & 6 stud)  
(Other Hubs by special order)

Straight, Overlay, 3" Drop, 4" Drop.

Black and Galv



### 63mm Square Axles

Bearings - 2.5 Tonne  
- 3 Tonne  
- 3 Tonne Parallel

Hubs - Landcruiser (5 & 6 stud)  
(Other Hubs by special order)

Straight, Overlay, 3" Drop, 4" Drop.

Black and Galv



## Special Orders

Manutec carries blank hubs that can be machined and studded to suit different stud patterns.

## Assembled Mechanical Brake Axles

### Mechanical Drum - 39mm Round/ 40mm Square

Bearings - A type (Holden)

Hubs - 9" drum (HT, HQ, Ford, Landcruiser, Commodore)

Backing plates - 9" mechanical

Straight, Overlay, 3" Drop, 4" Drop.



### Mechanical Drum - 45mm Square

Bearings - B type (Ford)

Hubs - 9" drum (HT, HQ, Ford, Mini, Landcruiser, Commodore)

Backing Plates - 9" Mechanical

Straight, Overlay, 3" Drop, 4" Drop.



### Mechanical Disc - 39mm Round/ 40mm Square

Bearings - A type (Holden)

Hubs - 10" disc (HT, HQ, Ford, Mini, Landcruiser, Commodore)

10" disc - Beehive/Velox(HT/Mini)

Straight, Overlay, 3" Drop, 4" Drop.



### Mechanical Disc - 45mm Square

Bearings

B type (Ford)

P type (Ford, LC6)

Hubs - 10", 11" & 12" disc

10" disc (F/HT/CD/HQ/LC)

10" disc - Beehive/Velox(HT/Mini)

11" disc (TL6 & P type)

12" disc (TL6, B type & P type)

12" disc (TL5, B type & P type)

Straight, Overlay, 3" Drop, 4" Drop.

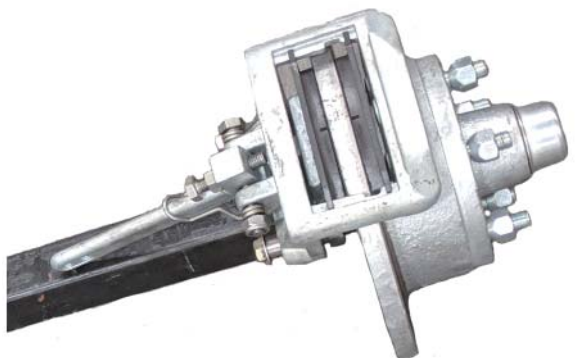

## Special Orders

Manutec carries blank hubs that can be machined and studded to suit different stud patterns.

## Assembled Electric Brake Axles

### 39mm Round/40mm Square (10" Drum)

Bearings-A Type (Holden)  
 Hubs - 10" drum (HT, HQ, Ford, Landcruiser, Commodore)  
 Backing plates - 10" electric (Alko/Dexter)  
 Options - Off road  
 Straight, Overlay, 3" Drop, 4" Drop.



### 45mm Square (10" Drum)

Bearings - B Type (Ford)  
 - P Type (Parallel-LC/Ford Only)  
 Hubs - 10" drum (HT, HQ, Ford, Landcruiser 5/6, Commodore)  
 Backing plates - 10" electric (Alko/Dexter)  
 Options - Off road  
 Straight, Overlay, 3" Drop, 4" Drop.



### 50mm Square (10" Drum)

Bearings - B Type (Ford)  
 - P Type (Parallel)  
 Hubs - 10" drum (HT, HQ, Ford, Landcruiser 5/6, Commodore)  
 Backing plates - 10" electric (Alko/Dexter)  
 Options - Off road  
 Straight, Overlay, 3" Drop, 4" Drop.



### 50mm Square (12" Drum)

Bearings - 2 tonne (Dexter)  
 - 2.25 tonne (Alko)  
 Hubs - 12" drum - 2 tonne drum (LC5) (LC6)  
 - 2.25 tonne drum (LC6)  
 Backing plates - 12" electric (Alko/Dexter)  
 Options - Off road  
 Straight, Overlay, 3" Drop, 4" Drop.



### 63mm Square (12" Drum)

Bearings - 2.5 tonne (Alko)  
 - 3 tonne  
 - 3 tonne parallel  
 Hubs - 12" - 2.5 tonne drum (LC6)  
 - 3 tonne (LC5/LC6)  
 - 3 tonne parallel (LC6)  
 Backing plates - 12" Electric (Alko/Dexter)  
 Options - Off road  
 Straight, Overlay, 3" Drop, 4" Drop.



## Special Orders

Manutec carries blank hubs that can be machined and studded to suit different stud patterns.

# Assembled Hydraulic Drum Brake Axles Hydraulic Drum

## 39mm Round/40mm Square (9" Drum)

Bearings - A type (Holden)

Hubs - 9" Drum (HT, HQ, Ford, Mini, Landcruiser, Commodore)

Backing plates - 9" hydraulic

Straight, Overlay, 3" Drop, 4" Drop.



## 45mm Square (9" and 10" Drum)

Bearings - B type (Ford)

- P type (Parallel-LC/Ford only)

Hubs - 9" & 10" Drum (HT, HQ, Ford, Landcruiser, Commodore)

Backing plates - 9" hydraulic & 10" hydraulic

Straight, Overlay, 3" Drop, 4" Drop.



## 50mm Square (10" Drum)

Bearings - B type (Ford)

- P type (Parallel)

Hubs - 10" Drum (HT, HQ, Ford, Landcruiser, Commodore)

Backing plates - 10" hydraulic

Straight, Overlay, 3" Drop, 4" Drop.



## 50mm Square (12" Drum)

Bearings - 2 tonne (Dexter)

- 2.25 tonne (Alko)

Hubs - 12" Drum - 2 tonne drum (LC5/LC6)

- 2.25 tonne drum (LC6)

Backing plates - 12" hydraulic (Option Single/Dual cylinder)

Straight, Overlay, 3" Drop, 4" Drop.



## 63mm Square (12" Drum)

Bearings - 2.5 tonne

- 3 tonne, 3 tonne parallel

Hubs - 12" Drum - 2.5 tonne drum (LC6)

- 3 tonne drum (LC5/LC6)

- 3 tonne parallel (LC6)

Backing plates - 12" hydraulic (Option Single/Dual cylinder)

Straight, Overlay, 3" Drop, 4" Drop.



## Special Orders

Manutec carries blank hubs that can be machined and studded to suit different stud patterns.

# Assembled Hydraulic Disc Brake Axles Hydraulic Disc

## 39mm Round/40mm Square

Bearings - A type (Holden)  
Hubs - 10" Disc (HT, HQ, Ford, Commodore)  
Straight, Overlay, 3" Drop, 4" Drop.



## 45mm Square

Bearings  
- B type (Ford)  
- P type (Parallel-LC/ Ford only)  
Hubs - 10" Disc B type (HT, HQ, Ford, Commodore)  
- 11" Disc P type (Landcruiser)  
- 12" Disc B type (Landcruiser)  
- 12" Disc P type (Landcruiser)  
Straight, Overlay, 3" Drop, 4" Drop.



## 50mm Square

Bearings - P type (Parallel)  
- 2 tonne(Dexter)  
- 2.25 tonne(ALKO)  
Hubs - 11" Disc P type (Landcruiser)  
- 11" Disc 2.25 tonne ALKO (Landcruiser)  
- 12" Disc P type (Landcruiser)  
- 12" Disc 2 tonne Dexter (Landcruiser)  
Straight, Overlay, 3" Drop, 4" Drop.



## 63mm Square

Bearings - 2.5 tonne  
- 3 tonne  
Hubs - 11" Disc 2.5 tonne ALKO (Landcruiser)  
- 12" Disc 3.0 tonne(Landcruiser)  
Straight, Overlay, 3" Drop, 4" Drop.



## Special Orders

Manutec carries blank hubs that can be machined and studded to suit different stud patterns.