

PCI Series - Polyurethane Cast Iron

Swivel Plate

Item Code	Wheel Dimensions	Height	Plate Size	Capacity
PCIS150	160mm x 50mm	195mm	135mm x 110mm	450kg
PCIS200	200mm x 50mm	238mm	135mm x 110mm	450kg

Fixed Plate

Item Code	Wheel Dimensions	Height	Plate Size	Capacity
PCIF150	160mm x 50mm	195mm	135mm x 110mm	450kg
PCIF200	200mm x 50mm	238mm	135mm x 110mm	450kg

Dimensions
 D = Wheel Diameter
 W = Width of Wheel

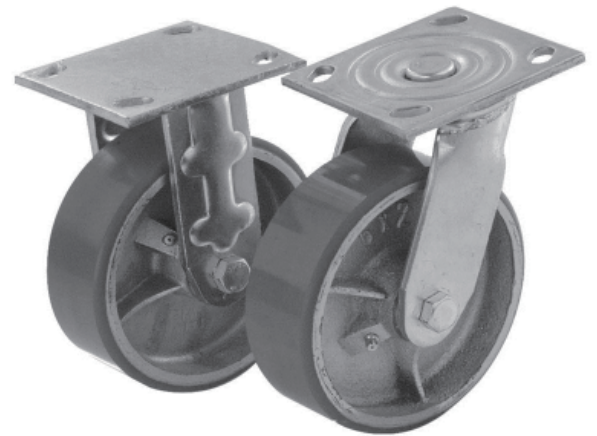
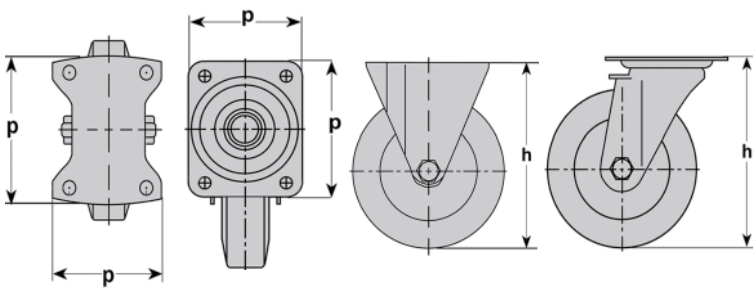

030 Series - Cast Iron

Swivel Plate

Item Code	Wheel Dimensions	Height	Plate Size	Capacity
030CI50	50mm x 20mm	64mm	67mm x 48mm	50kg
030CI63	63mm x 25mm	83mm	97mm x 67mm	70kg
030CI75	75mm x 32mm	95mm	105mm x 80mm	100kg
030CI100	100mm x 38mm	127mm	130mm x 103mm	200kg
030CI125	125mm x 40mm	153mm	142mm x 100mm	265kg

Fixed Plate

Item Code	Wheel Dimensions	Height	Plate Size	Capacity
031CI50	50mm x 20mm	64mm	69mm x 43mm	50kg
031CI63	63mm x 25mm	83mm	109mm x 53.5mm	70kg
031CI75	75mm x 32mm	95mm	102mm x 64mm	100kg
031CI100	100mm x 38mm	127mm	122mm x 77mm	200kg
031CI125	125mm x 40mm	153mm	150mm x 108mm	265kg

Dimensions
 D = Wheel Diameter
 W = Width of Wheel

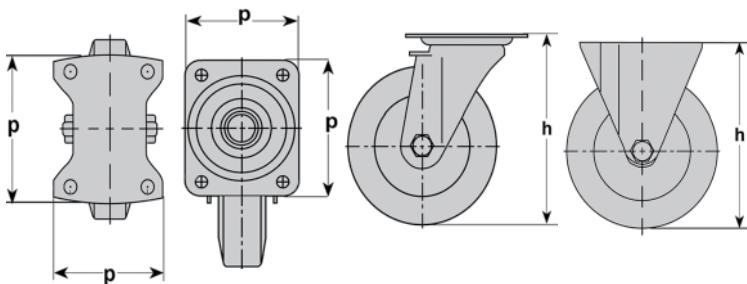

010 Series - Black Rubber Steel Centre

Swivel Plate

Item Code	Wheel Dimensions	Height	Plate Size	Capacity
010BR80	80mm x 25mm	105mm	105mm x 85mm	50kg
010BR100	100mm x 30mm	128mm	105mm x 85mm	70kg
010BR125	125mm x 37.5mm	156mm	105mm x 85mm	100kg
010BR150	160mm x 40mm	195mm	140mm x 110mm	135kg
010BR200	200mm x 50mm	235mm	140mm x 110mm	205kg

Swivel Plate With Side Brake

Item Code	Wheel Dimensions	Height	Plate Size	Capacity
010BR80B	80mm x 25mm	105mm	105mm x 85mm	50kg
010BR100B	100mm x 30mm	128mm	105mm x 85mm	70kg
010BR125B	125mm x 37.5mm	156mm	105mm x 85mm	100kg

Swivel Plate With Total Brake

Item Code	Wheel Dimensions	Height	Plate Size	Capacity
010BR80TB	80mm x 25mm	105mm	105mm x 85mm	50kg
010BR100TB	100mm x 30mm	128mm	105mm x 85mm	70kg
010BR125TB	125mm x 37.5mm	156mm	105mm x 85mm	100kg
010BR150TB	160mm x 40mm	195mm	140mm x 110mm	135kg
010BR200TB	200mm x 50mm	235mm	140mm x 110mm	205kg

Fixed Plate

Item Code	Wheel Dimensions	Height	Plate Size	Capacity
011BR80	80mm x 25mm	105mm	105mm x 85mm	50kg
011BR100	100mm x 30mm	128mm	105mm x 85mm	70kg
011BR125	125mm x 35mm	156mm	105mm x 85mm	100kg
011BR150	160mm x 40mm	195mm	140mm x 110mm	135kg
011BR200	200mm x 50mm	235mm	140mm x 110mm	205kg

Dimensions
 D = Wheel Diameter
 W = Width of Wheel

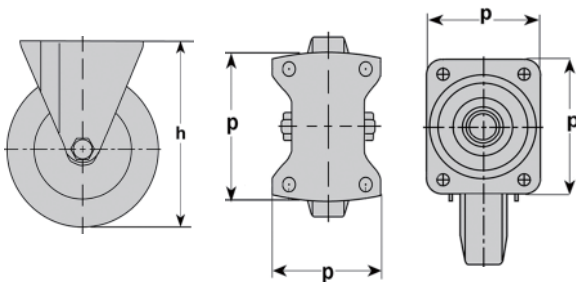

010 Series - Nylon Wheel

Swivel Plate

Item Code	Wheel Dimensions	Height	Plate Size	Capacity
010NY80	80mm x 32mm	105mm	105mm x 85mm	110kg
010NY100	100mm x 36mm	128mm	105mm x 85mm	128kg
010NY125	125mm x 37mm	156mm	105mm x 85mm	156kg

Swivel Plate With Side Brake

Item Code	Wheel Dimensions	Height	Plate Size	Capacity
010NY80B	80mm x 32mm	105mm	105mm x 85mm	110kg
010NY100B	100mm x 36mm	128mm	105mm x 85mm	128kg
010NY125B	125mm x 37mm	156mm	105mm x 85mm	156kg

Fixed Plate

Item Code	Wheel Dimensions	Height	Plate Size	Capacity
011NY80B	80mm x 32mm	105mm	105mm x 85mm	110kg
011NY100	100mm x 36mm	128mm	105mm x 85mm	128kg
011NY125	125mm x 37mm	156mm	105mm x 85mm	156kg

Dimensions
 D = Wheel Diameter
 W = Width of Wheel



030 Series - Solid Rubber

Swivel Plate

Item Code	Wheel Dimensions	Height	Plate Size	Capacity
030BR50	50mm x 20mm	64mm	65mm x 48mm	40kg
030BR63	63mm x 28mm	83mm	96mm x 67mm	60kg
030BR75	75mm x 32mm	95mm	105mm x 80mm	80kg
030BR100	100mm x 32mm	127mm	130mm x 103mm	85kg
030BR125	125mm x 38mm	158mm	150mm x 108mm	130kg

Swivel Plate With Side Brake

Item Code	Wheel Dimensions	Height	Plate Size	Capacity
030BR50B	50mm x 20mm	64mm	65mm x 48mm	40kg
030BR63B	63mm x 28mm	83mm	96mm x 67mm	60kg
030BR75B	75mm x 32mm	95mm	105mm x 80mm	80kg
030BR100B	100mm x 32mm	127mm	130mm x 103mm	85kg
030BR125B	125mm x 38mm	153mm	142mm x 108mm	130kg

Fixed Plate

Item Code	Wheel Dimensions	Height	Plate Size	Capacity
031BR50	50mm x 22mm	64mm	69mm x 43mm	40kg
031BR63	63mm x 28mm	83mm	109mm x 54mm	60kg
031BR75	75mm x 32mm	95mm	102mm x 64mm	80kg
031BR100	100mm x 32mm	127mm	122mm x 77mm	85kg
031BR125	125mm x 38mm	153mm	150mm x 108mm	130kg

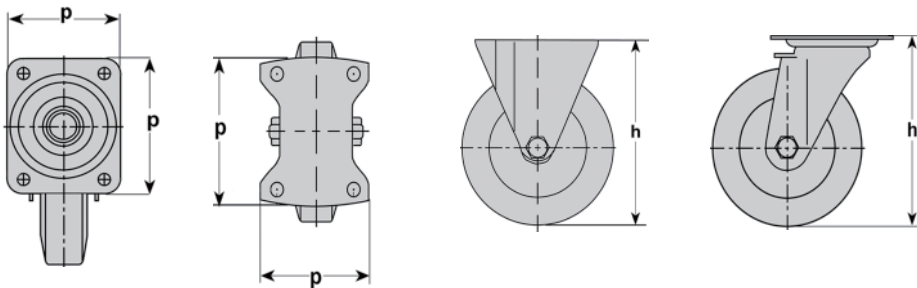

Dimensions

D = Wheel Diameter
W = Width of Wheel



030 Series - Nylon Wheel

Swivel Plate

Item Code	Wheel Dimensions	Height	Plate Size	Capacity
030NY50	50mm x 21mm	64mm	67mm x 48mm	45kg
030NY63	63mm x 28mm	83mm	96mm x 67mm	70kg
030NY75	75mm x 28mm	95mm	105mm x 80mm	100kg
030NY100	100mm x 36mm	127mm	130mm x 102mm	200kg
030NY125	125mm x 37mm	153mm	142mm x 100mm	265kg

Fixed Plate

Item Code	Wheel Dimensions	Height	Plate Size	Capacity
031NY50	50mm x 22mm	64mm	69mm x 43mm	45kg
031NY63	63mm x 28mm	83mm	109mm x 54mm	70kg
031NY75	75mm x 28mm	95mm	102mm x 64mm	100kg
031NY100	100mm x 35mm	127mm	122mm x 77mm	200kg
031NY125	125mm x 37mm	153mm	150mm x 108mm	265kg

Dimensions
 D = Wheel Diameter
 W = Width of Wheel

