

Manutec carries a full range of standard tow couplings up to 4.5 tonne. All standard couplings are fully tested and are ADR/CTA compliant. Test certificates and CTA approvals are available upon request.

For off-road towing Manutec has the OZHITCH range which caters for up to 3.5 tonne and also an override version of the Poly-Block coupling. All off-road couplings are ADR/CTA compliant and fully tested.

In addition to tow couplings Manutec also carries a large range of towing accessories, brake controllers, chain, D-shackles, hammerlocks, base plates, brake levers, electric components, hydraulic components and towing locks.

Standard Tow Couplings



MC2HD

Standard Coupling 2 Hole
To suit 50mm ball

| | |
|--------------|-----------------|
| Coating | Dacromet |
| Hole Pattern | Standard 2 Hole |
| Rating | 2 Tonne |
| Unit Weight | 2.9kg |
| ADR Rating | Approved |
| CTA# | 060705 |



MC3HD

Standard Coupling 3 Hole
To suit 50mm ball

| | |
|--------------|-----------------|
| Coating | Dacromet |
| Hole Pattern | Standard 3 Hole |
| Rating | 2 Tonne |
| Unit Weight | 2.9kg |
| ADR Rating | Approved |
| CTA# | 060704 |

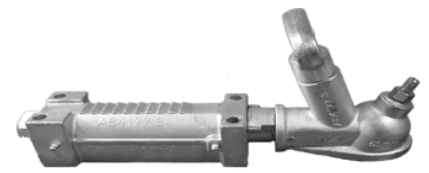

MOC2000D

Override Coupling
To suit 50mm ball

| | |
|--------------|-----------------|
| Coating | Dacromet |
| Hole Pattern | Standard 4 Hole |
| Rating | 2 Tonne |
| Unit Weight | 7.7kg |
| ADR Rating | Approved |
| CTA# | 060713 |



MOC-HYD-KIT

Override Coupling
Includes 3/4 master cylinder & bracket

| | |
|--------------|-----------------|
| Coating | Dacromet |
| Hole Pattern | Standard 4 Hole |
| Rating | 2 Tonne |
| Unit Weight | 9.5kg |
| ADR Rating | Approved |
| CTA# | 060713 |



MC3500Z

Electric Coupling with Hand Brake
To suit 50mm ball

| | |
|--------------|-----------------|
| Coating | Dacromet |
| Hole Pattern | Standard 4 Hole |
| Rating | 3.5 Tonne |
| Unit Weight | 8.0kg |
| ADR Rating | Approved |
| CTA# | 060712 |



MC4500G

Electric Coupling with Hand Brake
To suit 70mm ball

| | |
|--------------|-----------------|
| Coating | Dacromet |
| Hole Pattern | Standard 4 Hole |
| Rating | 4.5 Tonne |
| Unit Weight | 10.45kg |
| ADR Rating | Approved |
| CTA# | 060789 |

Offroad Couplings



OZHITCH-OR-G-4H

Off Road Override Coupling

| | |
|--------------|-----------------|
| Coating | Galvanised |
| Hole Pattern | Standard 4 Hole |
| Rating | 2 Tonne |
| Unit Weight | 10.9kg |
| ADR Rating | Approved |
| CTA# | 060792 |

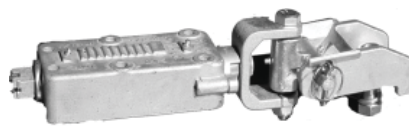

OZHITCH-OR-G-6H

Off Road Coupling

| | |
|--------------|-----------------|
| Coating | Galvanised |
| Hole Pattern | Standard 6 Hole |
| Rating | 2 Tonne |
| Unit Weight | 13kg |
| ADR Rating | Approved |
| CTA# | 060791 |



OZHITCH2.5G-4H

Off Road Coupling

| | |
|--------------|---------------------|
| Coating | Galvanised |
| Hole Pattern | Non-Standard 4 Hole |
| Rating | 2.5 Tonne |
| Unit Weight | 9kg |
| ADR Rating | Approved |
| CTA# | 060744 |



OZHITCH3.5G-4H

Off Road Coupling

| | |
|--------------|-----------------|
| Coating | Galvanised |
| Hole Pattern | Standard 4 Hole |
| Rating | 3.5 Tonne |
| Unit Weight | 11.5kg |
| ADR Rating | Approved |
| CTA# | 060802 |



OZHITCH3.5G-6H

Off Road Coupling

| | |
|--------------|-----------------|
| Coating | Galvanised |
| Hole Pattern | Standard 6 Hole |
| Rating | 3.5 Tonne |
| Unit Weight | 11.5kg |
| ADR Rating | Approved |
| CTA# | 060803 |



MOC2000D - PB

Override Coupling Poly Block

| | |
|--------------|-----------------|
| Coating | Dacromet |
| Hole Pattern | Standard 4 Hole |
| Rating | 2 Tonne |
| Unit Weight | 7.7kg |
| ADR Rating | Approved |
| CTA# | 060705 |

Ring Couplings & Pintle Hooks



CM255

Unbraked Fix Ring 75MM
Pintle Ring Coupling D -
Value 47.5kN – 6t CTA-045953



CM535

6 Tonne Pintle Hook 2 inch
Receiver Bar
CTA-Pending

Coupling Component Type Approvals (CTAs)

Australian Government
 Department of Infrastructure, Transport,
 Regional Development, Communications and the Arts

VSS.NCE.11.01.01

Road Vehicle Component Type Approval

The following component has been granted a component type approval under section 177 of the Road Vehicle Standards Rules 2019. The component fully complies with the applicable national road vehicle standards.

Manutec
 MC2HD

Approval holder: MANUTEC PTY. LTD.
 Approval number: CTA-060705
 This approval is valid from: 16/09/2022
 Approval expires on: 15/09/2029 (unless revoked earlier)

This component type approval is subject to the conditions set out in the attachment to this approval notice.

Umesh Shandasani
 Delegate of the Secretary
 Vehicle Safety Operations Branch
 Department of Infrastructure, Transport, Regional Development, Communications and the Arts
 16/09/2022

MC2HD - CTA-060705

Australian Government
 Department of Infrastructure, Transport,
 Regional Development, Communications and the Arts

VSS.NCE.11.01.01

Road Vehicle Component Type Approval

The following component has been granted a component type approval under section 177 of the Road Vehicle Standards Rules 2019. The component fully complies with the applicable national road vehicle standards.

Manutec
 MC2HD

Approval holder: MANUTEC PTY. LTD.
 Approval number: CTA-060705
 This approval is valid from: 16/09/2022
 Approval expires on: 11/09/2029 (unless revoked earlier)

This component type approval is subject to the conditions set out in the attachment to this approval notice.

Umesh Shandasani
 Delegate of the Secretary
 Vehicle Safety Operations Branch
 Department of Infrastructure, Transport, Regional Development, Communications and the Arts
 16/09/2022

MC3HD - CTA-060704

Australian Government
 Department of Infrastructure, Transport,
 Regional Development, Communications and the Arts

VSS.NCE.11.01.01

Road Vehicle Component Type Approval

The following component has been granted a component type approval under section 177 of the Road Vehicle Standards Rules 2019. The component fully complies with the applicable national road vehicle standards.

Manutec
 MC3500Z

Approval holder: MANUTEC PTY. LTD.
 Approval number: CTA-060715
 This approval is valid from: 16/09/2022
 Approval expires on: 1x/09/2029 (unless revoked earlier)

This component type approval is subject to the conditions set out in the attachment to this approval notice.

Umesh Shandasani
 Delegate of the Secretary
 Vehicle Safety Operations Branch
 Department of Infrastructure, Transport, Regional Development, Communications and the Arts
 16/09/2022

MC3500Z - CTA-060712

Australian Government
 Department of Infrastructure, Transport,
 Regional Development, Communications and the Arts

VSS.NCE.11.01.01

Road Vehicle Component Type Approval

The following component has been granted a component type approval under section 177 of the Road Vehicle Standards Rules 2019. The component fully complies with the applicable national road vehicle standards.

Manutec
 MC4500G

Approval holder: MANUTEC PTY. LTD.
 Approval number: CTA-060789
 This approval is valid from: 30/11/2022
 Approval expires on: 29/11/2029 (unless revoked earlier)

This component type approval is subject to the conditions set out in the attachment to this approval notice.

Umesh Shandasani
 Delegate of the Secretary
 Vehicle Safety Operations Branch
 Department of Infrastructure, Transport, Regional Development, Communications and the Arts
 30/11/2022

MC4500G- CTA-060789

Australian Government
 Department of Infrastructure, Transport,
 Regional Development, Communications and the Arts

VSS.NCE.11.01.01

Road Vehicle Component Type Approval

The following component has been granted a component type approval under section 177 of the Road Vehicle Standards Rules 2019. The component fully complies with the applicable national road vehicle standards.

Manutec
 MOC2000D

Approval holder: MANUTEC PTY. LTD.
 Approval number: CTA-060715
 This approval is valid from: 16/09/2022
 Approval expires on: 11/09/2029 (unless revoked earlier)

This component type approval is subject to the conditions set out in the attachment to this approval notice.

Umesh Shandasani
 Delegate of the Secretary
 Vehicle Safety Operations Branch
 Department of Infrastructure, Transport, Regional Development, Communications and the Arts
 16/09/2022

MOC2000D - CTA-060713

Australian Government
 Department of Infrastructure, Transport,
 Regional Development, Communications and the Arts

VSS.NCE.11.01.01

Road Vehicle Component Type Approval

The following component has been granted a component type approval under section 177 of the Road Vehicle Standards Rules 2019. The component fully complies with the applicable national road vehicle standards.

Manutec
 MOC2000D-PB

Approval holder: MANUTEC PTY. LTD.
 Approval number: CTA-060711
 This approval is valid from: 16/09/2022
 Approval expires on: 1x/09/2029 (unless revoked earlier)

This component type approval is subject to the conditions set out in the attachment to this approval notice.

Umesh Shandasani
 Delegate of the Secretary
 Vehicle Safety Operations Branch
 Department of Infrastructure, Transport, Regional Development, Communications and the Arts
 16/09/2022

MOC2000D-PB - CTA-060711

Australian Government
 Department of Infrastructure, Transport,
 Regional Development, Communications and the Arts

VSS.NCE.11.01.01

Road Vehicle Component Type Approval

The following component has been granted a component type approval under section 177 of the Road Vehicle Standards Rules 2019. The component fully complies with the applicable national road vehicle standards.

Manutec
 OZHITCH2.5G-4H

Approval holder: MANUTEC PTY. LTD.
 Approval number: CTA-060755
 This approval is valid from: 15/10/2022
 Approval expires on: 1x/10/2029 (unless revoked earlier)

This component type approval is subject to the conditions set out in the attachment to this approval notice.

Umesh Shandasani
 Delegate of the Secretary
 Vehicle Safety Operations Branch
 Department of Infrastructure, Transport, Regional Development, Communications and the Arts
 15/10/2022

OZHITCH2.5G-4H- CTA-060744

Australian Government
 Department of Infrastructure, Transport,
 Regional Development, Communications and the Arts

VSS.NCE.11.01.01

Road Vehicle Component Type Approval

The following component has been granted a component type approval under section 177 of the Road Vehicle Standards Rules 2019. The component fully complies with the applicable national road vehicle standards.

Manutec
 OZHITCH-OR-G-6H

Approval holder: MANUTEC PTY. LTD.
 Approval number: CTA-060781
 This approval is valid from: 01/09/2023
 Approval expires on: 20/09/2038 (unless revoked earlier)

This component type approval is subject to the conditions set out in the attachment to this approval notice.

Umesh Shandasani
 Delegate of the Secretary
 Vehicle Safety Operations Branch
 Department of Infrastructure, Transport, Regional Development, Communications and the Arts
 01/09/2023

OZHITCH-OR-G-6H- CTA-060791

Australian Government
 Department of Infrastructure, Transport,
 Regional Development, Communications and the Arts

VSS.NCE.11.01.01

Road Vehicle Component Type Approval

The following component has been granted a component type approval under section 177 of the Road Vehicle Standards Rules 2019. The component fully complies with the applicable national road vehicle standards.

Manutec
 OZHITCH-OR-G-6H

Approval holder: MANUTEC PTY. LTD.
 Approval number: CTA-060781
 This approval is valid from: 01/09/2023
 Approval expires on: 20/09/2038 (unless revoked earlier)

This component type approval is subject to the conditions set out in the attachment to this approval notice.

Umesh Shandasani
 Delegate of the Secretary
 Vehicle Safety Operations Branch
 Department of Infrastructure, Transport, Regional Development, Communications and the Arts
 01/09/2023

Towing



MPBA

Poly Block Adaptor

With draw bar pin

| | |
|-------------|---------|
| Coating | Painted |
| Unit Weight | 2.40kg |
| CTA# | 060710 |



MTB50-R

50mm Towball

| | |
|-------------|-----------|
| Coating | Chrome |
| Rating | 3.5 Tonne |
| Unit Weight | 1.45kg |
| ADR Rating | Approved |

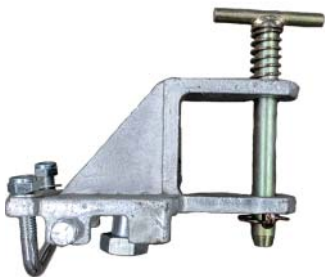

MPBA-C

Poly Block Adaptor

With draw bar pin

| | |
|-------------|--------|
| Coating | Zinc |
| Unit Weight | 4.3kg |
| CTA# | 060709 |



MTB50HR-SS

50mm Hi-Rise Towball

| | |
|-------------|-----------------|
| Coating | Stainless Steel |
| Rating | 2 Tonne |
| Unit Weight | 1.45kg |



DBP-MPBA

Draw Bar Pin

| | |
|-------------|-------|
| Coating | Zinc |
| Unit Weight | 0.5kg |



MTB70-ADR

70mm Towball

| | |
|-------------|-----------|
| Coating | Chrome |
| Rating | 4.5 Tonne |
| Unit Weight | 3.6 kg |
| ADR Rating | Approved |
| CTA# | 060850 |



MTT2/MTT2-70mm

Towing Hitch

Standard 2" tongue removable

| | |
|-------------|------------|
| Coating | Painted |
| Rating | 2.25 Tonne |
| Unit Weight | 3.3kg |

50mm and 70mm option



MTB2-5/6

2 5/6" Towball

| | |
|-------------|-----------|
| Coating | Chrome |
| Rating | 3.5 Tonne |
| Unit Weight | 1.45kg |
| ADR Rating | Approved |



MTBR32-22

Towball Reducer

32mm-22mm

| | |
|-------------|----------|
| Coating | |
| Rating | |
| Unit Weight | |
| ADR Rating | Approved |

Base Plates

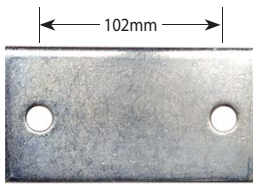

MCBP2

Mounting Plate - 2 Hole

To suit standard 2 hole couplings

| | |
|--------------|-----------------|
| Hole Spacing | 102mm |
| Hole Pattern | Standard 2 Hole |
| Coating | zinc |
| Unit Weight | 0.70kg |

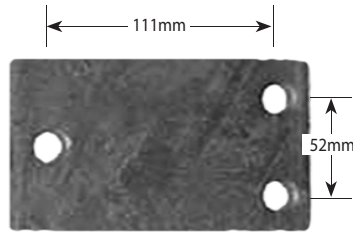

MCBP3

Mounting Plate - 3 Hole

To suit standard 3 hole couplings

| | |
|--------------|-----------------|
| Hole Spacing | 52mm & 111mm |
| Hole Pattern | Standard 3 Hole |
| Coating | zinc |
| Unit Weight | 0.80kg |

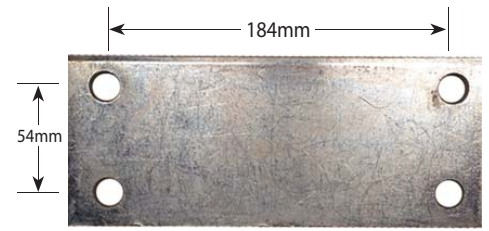

MCBP4

Mounting Plate - 4 Hole

To suit standard 4 hole couplings

| | |
|--------------|-----------------|
| Hole Spacing | 54mm & 184mm |
| Hole Pattern | Standard 4 Hole |
| Coating | zinc |
| Unit Weight | 1.35kg |

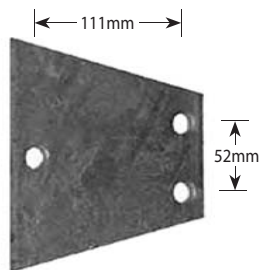

MCBP3V

V Shape Mounting Plate

To suit standard 3 hole couplings

| | |
|--------------|-----------------|
| Hole Spacing | 52mm & 111mm |
| Hole Pattern | Standard 2 Hole |
| Coating | zinc |
| Unit Weight | 1.05kg |

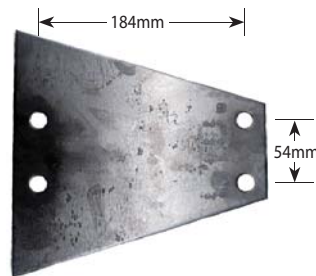

MCBP4V

Mounting Plate - 4 Hole

To suit standard 4 hole couplings

| | |
|--------------|-----------------|
| Hole Spacing | 54mm & 184mm |
| Hole Pattern | Standard 4 Hole |
| Coating | zinc |
| Unit Weight | 1.6kg |

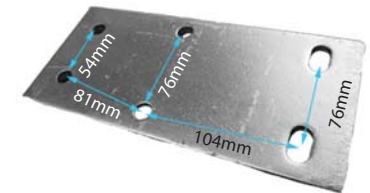

MCBP6

Mounting Plate - 6 Hole

To suit standard 4 hole/6 hole couplings

| | |
|--------------|---|
| Hole Spacing | 52mm & 111mm |
| Hole Pattern | Standard 6 Hole Non Standard 4 Hole Standard 4 Hole |
| Coating | zinc |
| Unit Weight | 1.8kg |



MMAP-G

Mounting Plate with Handbrake

To suit mechanical override coupling MOC2000D

| | |
|--------------|-----------------|
| Hole Pattern | Standard 4 Hole |
| Coating | Dacromet |
| Unit Weight | 2.15kg |



MCBPL

Mounting Plate with Handbrake

To suit mechanical override coupling MOC2000D

| | |
|--------------|-----------------|
| Hole Pattern | Standard 4 Hole |
| Coating | Zinc |
| Unit Weight | 2.30kg |



HBRAKEASS

Quick Release Ratchet Style Handbrake assembly for mechanical brakes

| | |
|--------------|------------------------|
| Hole Pattern | Standard 4 Hole (Rear) |
| Coating | zinc |
| Unit Weight | 1.0kg |



MCBPL-75MM

Mounting Plate with Handbrake

To suit 75mm draw bar

| | |
|--------------|-----------------|
| Hole Pattern | Standard 4 Hole |
| Coating | Zinc |
| Unit Weight | 2.30kg |

Locks

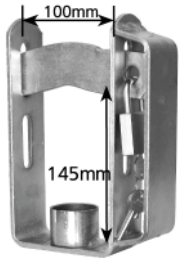

TWINCOUPLLOCK

Coupling Lock - Twin Position Type

Can be used two ways.

1. Mounted onto towbar to prevent coupling detachment from tow ball.
2. Fitted directly onto coupling to prevent attachment of coupling to tow ball.

Unit weight 1.68kg

Coating Zinc



PADLOCK40

40mm Brass Padlock

Padlock supplied with 3 keys

Unit weight 0.27kg



PADLOCK50

50mm Brass Padlock

Padlock supplied with 3 keys

Unit weight 0.28kg

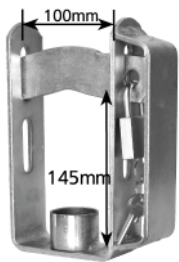

TWINCOUPLW/PL

Coupling Lock Twin Position Type with 40mm Padlock

Can be used two ways.

1. Mounted onto towbar to prevent coupling detachment from tow ball.
2. Fitted directly onto coupling to prevent attachment of coupling to tow ball.

Unit weight 2.0kg

Coating Zinc



MTCP1407

Coupling Release Lever Lock

Suit ball couplings release lever lock, OZHITCH connecting pin & MCTP-Z/C supplied with 2 keys.

Unit weight 0.25kg

Coating Zinc



SINGCOUPLLOCK

Coupling Lock Single

Suit standard couplings. Prevents attachment of coupling to tow ball

Unit weight 1.44kg

Coating Zinc



MCTP-Z

Coupling Tongue Pin and R Clip

Now with two R clip holes and an additional hole for padlocks

Unit weight 0.68kg

Coating Yellow Zinc



MTCP1405

Towing Hitch Tongue Lock

Tongue lock, supplied with 2 keys and rubber end cap.

To suit standard towing hitch MTT2

Unit weight 0.55kg

Coating Zinc



MCTP-C

Coupling Tongue Pin and R Clip

Now with two R clip holes and an additional hole for padlocks

Unit weight 0.68kg

Coating Chrome

Offroad Towing

MSTAB

CARAVAN WEIGHT DISTRIBUTION SYSTEM

| | |
|-------------|---------|
| Coating | Painted |
| Unit weight | 38.7kg |

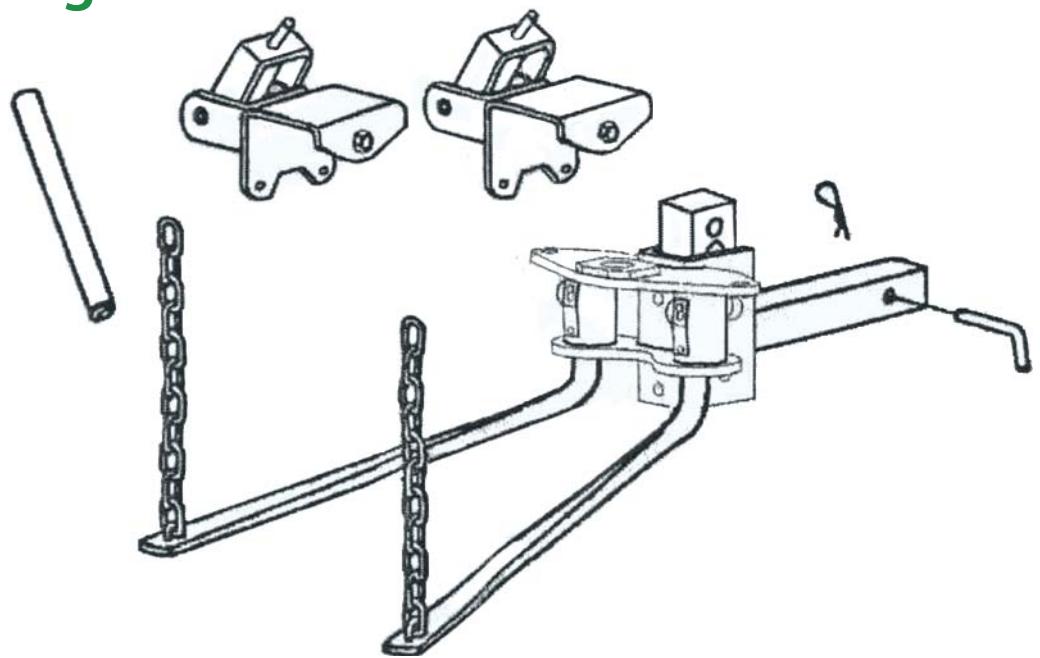

Why use a weight distribution system?

Towing a caravan or trailer will inevitably add weight to the rear of your vehicle. This added weight can alter the handling of the vehicle, due to an imbalance of weight from the front to the rear. This can pose serious safety concerns, especially when travelling at high speeds, as less weight over the front axle will reduce braking efficiency and steering control. In addition, the weight imbalance can throw headlights out of alignment (see Figure 1) and significantly increase fuel use and tyre wear. The Weight Distribution System has been designed to address these problems, by restoring even balance across all axles of the vehicle and trailer or caravan. The purpose of the system is to enable the vehicle to be driven at the maximum legal speed, without compromising on safety.



Figure 1. Incorrect weight distribution

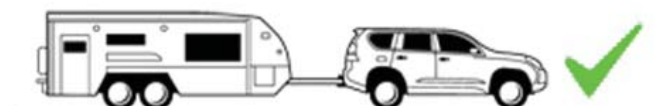
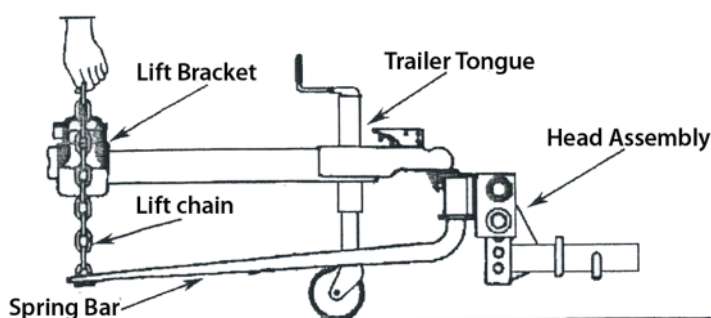

Figure 2. Correct weight distribution

How does the weight distribution system work?

The weight distribution system works by changing the point at which the load of the trailer is transferred to the vehicle. Without a weight distribution system, the entire weight of the trailer is transferred and carried at the towball, as shown above in Figure 1. This is corrected by redistributing the weight across all axles of the vehicle and caravan or trailer (see Figure 2), similar to the lifting action of a wheelbarrow. The Manutec Weight Distribution System has been engineered to ensure towing vehicles operate at their optimum braking, steering and driving capacity.



D-Shackles

| Item code | WLL Rating | *ATM Rating | ADR |
|-----------------|------------------------|-------------|----------|
| D-SHACKLE-0.75T | 750KG Rated D-Shackle | 3000KG | approved |
| D-SHACKLE-1.0T | 1000KG Rated D-Shackle | 4000KG | approved |
| D-SHACKLE-1.5T | 1500KG Rated D-Shackle | 6000KG | approved |
| D-SHACKLE-2.0T | 2000KG Rated D-Shackle | 8000KG | approved |



B-Shackles

| Item code | WLL Rating | *ATM Rating | ADR |
|-----------------|------------------------|-------------|----------|
| B-SHACKLE-0.75T | 750KG Rated B-Shackle | 3000KG | approved |
| B-SHACKLE-1.0T | 1000KG Rated B-Shackle | 4000KG | approved |
| B-SHACKLE-1.5T | 1500KG Rated B-Shackle | 6000KG | approved |



Safety Chain

| Item code | *ATM Rating | | | ADR |
|-------------------|-------------|------------|--------------|----------|
| MSCH1.6T-10L | 1.6 tonne | 8mm Black | 10 links | approved |
| MSCH1.6TG-10L | 1.6 tonne | 8mm Galv | 10 links | approved |
| MSCH2.5T-10L | 2.5 tonne | 8mm Black | 10 links | approved |
| MSCH2.5T-12L | 2.5 tonne | 10mm Black | 12 links | approved |
| MSCH2.5T-13L | 2.5 tonne | 10mm Black | 13 links | approved |
| MSCH2.5TG-13L | 2.5 tonne | 10mm Galv | 13 links | approved |
| MSCH2.5T-19L | 2.5 tonne | 10mm Black | 19 links | approved |
| MSCH3.5T-10L | 3.5 tonne | 13mm Black | 10 links | approved |
| MSCH3.5TG-10L | 3.5 tonne | 13mm Galv | 10 links | approved |
| SAFETYCHAIN8 | 1.6 tonne | 8mm Black | Linear Metre | approved |
| SAFETYCHAIN8GALV | 1.6 tonne | 8mm Galv | Linear Metre | approved |
| SAFETYCHAIN10 | 2.5 tonne | 10mm Black | Linear Metre | approved |
| SAFETYCHAIN10GALV | 2.5 tonne | 10mm Galv | Linear Metre | approved |
| SAFETYCHAIN13 | 3.5 tonne | 13mm Black | Linear Metre | approved |
| SAFETYCHAIN13GALV | 3.5 tonne | 13mm Galv | Linear Metre | approved |
| G100SAFETYCHAIN10 | 16.0 tonne | 10mm | Linear Metre | approved |
| G80SAFETYCHAIN13 | 26.8 tonne | 13mm | Linear Metre | approved |



*Note: WLL = Safe Working Load Limit
ATM = Aggregate Trailer Mass

Safety Chain - Bags

| Item code | Description |
|--------------------------|---|
| MSCH1.6TG-25KG-BAG CHAIN | SAFETY CHAIN 1.6T - 25KG BAG ONLY- GALV |
| MSCH2.5TG-25KG-BAG CHAIN | SAFETY CHAIN 2.5T - 25KG BAG ONLY- GALV |
| MSCH3.5TG-25KG-BAG CHAIN | SAFETY CHAIN 3.5T - 25KG BAG ONLY- GALV |

Draw Bar Pins

Includes chain, spring & clip

| Item code | Size | Coating | Weight |
|-------------|----------------------|-----------|--------|
| DBP12X110 | 12 x 110 | Gold Zinc | 600mm |
| DBP16X98 | 16 x 98 (5/8") | Gold Zinc | 900mm |
| DBP16X187 | 16 x 187 | Gold Zinc | 900mm |
| DBP19X98 | 19 x 98 (3/4") | Gold Zinc | 900mm |
| DBP20X230 | 20 x 230 | Gold Zinc | 900mm |
| DBP20X230 | 22 x 159 (7/8") | Gold Zinc | 600mm |
| DBP25.4X159 | 25.4 x 159 (1") | Gold Zinc | 900mm |
| DBP25.4X183 | 25.4 x 183 (1") | Gold Zinc | 900mm |
| DBP28.6X184 | 28.6 x 184 (11/8") | Gold Zinc | 600mm |
| DBP32X184 | 32mm x 184mm (11/4") | Gold Zinc | 900mm |

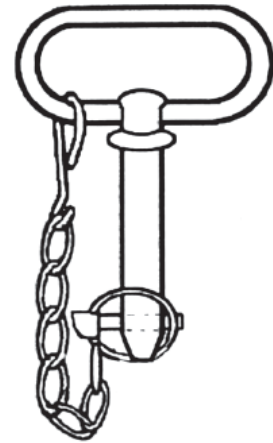

Chain Connecting Brackets

| Item code | Rated |
|------------|------------|
| MBRKT3.15T | 3.15 tonne |
| MBRKT5.3T | 5.3 tonne |



Hammerlocks/Butterfly Clip

| Item code | Rated | ADR Rating | Colour |
|------------|------------|------------|--------|
| MBCL2.0T | 2 tonne | Approved | Red |
| MBCL2.0T-Y | 2 tonne | Approved | Yellow |
| MBCL3.15T | 3.15 tonne | Approved | Red |
| MBCL5.3T | 5.3 tonne | Approved | Red |



Bracket and Butterfly Clip Sets

| Item code | Rated |
|---------------|------------|
| MBCL3.15T-SET | 3.15 tonne |
| MBCL5.3T-SET | 5.3 tonne |



Braking systems



MHA1200-CAP
Replacement cap
For hydrastar

Unit Weight 2.0kg



MCCBRKAWAY
Brake Away Coil
Cable

Unit Weight 0.01kg



MSWBRKAWAY
Brake Away Switch

Unit Weight 0.05kg



MTMEBC-AME
Trailer Mount Electric
Brake Controller

Unit Weight 0.35kg



MEBC-P
Electric Brake Controller
Primus IQ 90160
Proportionate brake
controller to suit 1-3 axles

Unit Weight 2.9kg



MHA1200
Hydraulic Brake Actuator
1200 PSI unit

Unit Weight 2.9kg



MHA1600
Hydraulic Brake Actuator
1600 PSI unit

Unit Weight 5.65kg



MBBRKAWAY
Brake Away System

Unit Weight 2.0kg



MBS6000
6000 Brake Safe Kit

Unit Weight 2.9kg



EBRH-ACCV3
Redarc Tow-Pro Elite V3
Electric Trailer Brake
Controller 12/24V input
up to 3 Axles, Remote
switch active calibration

Elecbrakes Bluetooth Electric Brake Controller



ELBC2000-PS
Elecbrakes Electric Brake
Controller

The elecbrake EB2 brake controller is a trailer mounted proportional brake controller. The device can be used with the plug and play adaptors or hardwired to the trailers electrical circuits with a leader. The device is fitted with an IP68 connector. Allows compliance with ADR38/05.



EBR-REMOTE
Remote Control

Elecbrakes in-car remote control. Allows user to control brake response, select user defined programs and activate trailer brakes only by the manual override button. Allows compliance with ADR38/04.



TWL
Trailer Wired Leader

Leader pre-wired with Deutsch plug to suit both ELBC2000-PS and EB2 units. This leader can be internally routed through the trailer chassis as required.



A7-7
Plug + Play Adaptor

Plug and Play Adaptors allow the Elecbrakes device to be easily installed onto the trailer. No wiring is required. The range of available Adaptors suits most combinations of trailer plugs and vehicle sockets.

* Other adaptors available

Brake Spare Parts - Hydraulic



MHB34MC

3/4" Master Cylinder
With bracket

| | |
|-------------|-------|
| Unit weight | 1.8kg |
| Coating | zinc |



BH400

Flexible Brake Hose 400mm long

| | |
|-------------|-------|
| Unit weight | ?? kg |
|-------------|-------|



Brass Nut

| Item Code | Tube Length |
|-----------|-------------|
| BSN | standard |
| BLN | long |

Bundy Tube

| Unit Weight | Length | Dimensions | Finish |
|-------------|--------|-------------|--------|
| MCBT15 | 15m | 3/16 x 17mm | Copper |
| MSBT20 | 20m | 3/16x.71mm | Steel |
| MSBT100 | 100m | 3/16x.71mm | Steel |



Brake Spare Parts - Hydraulic



M19MC

3/4 Master Cylinder

Unit Weight 0.45kg



M78MC

7/8 Master Cylinder

Unit Weight 0.5kg



MHB

Master Cylinder Bracket

Unit Weight 1.25kg



HBRAKEASS

Handbrake Assembly
for mechanical brakes

Unit weight 1.0kg

Coating Zinc



Brake Cable(SS)

| Item Code | Length |
|-----------|--------|
| MSSBC8 | 8m |
| MSSBC10 | 10m |

Also available cut to length



Wire Rope Grips

| Item Code | Size |
|-----------|------|
| MWRG | 5mm |
| MWRG6MM | 6mm |
| MWRG8MM | 8mm |
| MWRG10MM | 10mm |
| MWRG12MM | 12mm |

DRAWBARBKPLT3

Mechanical Brake Lever

For override coupling.

To suit a 3" draw bar

Unit weight 1.8kg

Coating Galv



Brake Cable Adjuster

| Item Code | Tube Length | Finish | Weight | Coating |
|----------------|--------------------------|-----------------|--------|---------|
| BRKCABL-ADJ | Brake Cable Adjuster | | 0.25kg | Zinc |
| BRKCABL-ADJ-HD | Brake Cable Adjuster KIT | Stainless Steel | 0.35kg | Zinc |
| BRKCABL-HDSET | Brake Cable Adjuster Set | | 0.25kg | |
| BRKCABL-KIT-SS | Brake Cable Adjuster KIT | Stainless Steel | 0.35kg | |



Ozhitch Spare Parts



OZHUNIJOINT

Universal Joint
with bearings fitted

Coating Zinc

Unit Weight 0.70kg



OZHFRNTBKT-G

Front Bracket
with Bolt/Nut OZHITCH3.5G

Coating Galv

Unit Weight 2.7kg
(Connecting Pin Not Supplied)



OZHFRKBOLT

Fork Bolt
Bolt/Nyloc to suit OZHITCHES

Coating Galv/Zinc

Unit Weight 0.40kg



OZHCONPIN

Connection Pin
With lynch pin OZHITCH3.5

Coating Galv/Zinc

Unit Weight 0.5kg



OZHBRGSET

Bush Set
Bush set of OZHITCH3.5 bushes
2 large and 4 small

Coating Zinc

Unit Weight 0.06kg



BOLT12X2

HT Bolt 1/2 inch x 2 inch
Suits OZHITCH 6H and 2.5T-4H
and bolt on STD couplings

includes Bolt, Nut, Washer, Spring Washer

Unit Weight 0.5kg



BOLT12X2.5

HT Bolt 1/2 inch x 2.5 inch
Suits OZHITCH 6H and 2.5T-4H
and bolt on STD couplings

includes Bolt, Nut, Washer, Spring Washer

Unit Weight 0.5kg



BOLT12X4

HT Bolt 1/2 inch x 4 inch
Suit OZHITCH3.5G-4H,
OZHITCH-OR-G-4H,
OZHITCH-OR-G-6H & MOC2000Z.

includes Bolt, Nut, Washer, Spring

Unit Weight 0.5kg



HBRAKEASS

Handbrake Assembly
For mechanical brakes

Unit Weight 1.0kg

Coating Zinc

OZHITCH Fork

| Item Code | To suit | |
|-----------------|-----------------|-------|
| OZHFRKSH2.5-4H | OZHITCH2.5G-4H | 205mm |
| OZHFRKSH3.5-4H | OZHITCH3.5G-4H | 270mm |
| OZHFRKSH3.5-6H | OZHITCH3.5G-6H | 215mm |
| OZHFRKSH2TOR-4H | OZHITCH-OR-G-4H | 265mm |
| OZHFRKSH2TOR-6H | OZHITCH-OR-G-6H | 285mm |



Ozhitch Spare Parts



OZHFRBKT-KIT

Ozhitch Receiver Bracket and connecting pin and bolt

Unit weight 3.1kg



OZHBRGSET-SML

Bushes

To suit OZHUNIJT - 4 x SML bushes

Unit weight 0.1kg



OZHCONPIN-SPRING

Spring for Ozhitch connector pin spring For OZHITCH con pin

Unit weight 0.1kg



OZHM22RBOLT

Bolt (72mm X 22mm), Nut, Spring Washer To suit Ozhitch receiver bracket bolt 72mm x22mm - M22 Bolt/Nut/Spring Washer

Unit weight 0.3kg



OZHBRKEXTPLT

Coupling Bolt-On 45mm Brake Extension Suits standard 4 Hole and 6 Hole couplings

Unit weight 0.3kg



RHBRKEXT

Hand Brake Lever Extension Piece Bolt on Suits HRBRAKEASS

Unit weight 0.25kg



OZH7/16-14TPIRBOLT

Bolt 7/16 in x 1.25 in - 14 TPI Bolt/Nut Small Side Bolts To suit OZHITCH receiver bracket

Unit weight 0.1kg

Spare Parts - Couplings



VINPLATE-B
Blank Vehicle Identification Plate
VEHICLE STANDARD ACT 1989
Black



VINPLATE-S
Blank Vehicle Identification Plate
VEHICLE STANDARD ACT 1989
Silver



VINPLATE-B-R
Blank Vehicle Identification Plate
ROVER STYLE
Black- Pre Drilled



VINPLATE-S-R
Blank Vehicle Identification Plate
ROVER STYLE
Silver - Pre Drilled



MOC2000HSC
Handle and Safety Catch
Suits MOC2000D



MOC2000LPS
Locking Plunger and Spring
Suits MOC2000D



DBPSRING-MPBA
Draw Bar Pin Spring
Suits poly block adaptor



MCARPN (1/2" UNC)
Anti Rattle Pin & Bolt
To suit standard ball couplings



MOC2000SC
Coupling Release
Safety Catch
Coating Zinc



HANDGRIP20X120
Black Handle Grip
20MM X 120MM



MOC2000RS
Reversing Stop Spare part For
override coupling suits MOC2000D
Coating Zinc



MPBA-LINCH-PIN
Linch pin
To suit poly block adaptor



RCLIP
RCLIP50 50mm x 2mm
RCLIP70 70mm x 2mm
RCLIP120 120mm x 3.5mm



MC4500-BUSH
Cylindrical Anti-Rattle Bush Set
Suits MC4500 coupling

OzHitch Hole Patterns

Standard 4 Hole

3.5 Tonne/4.5 Tonne/2.0 Tonne Override

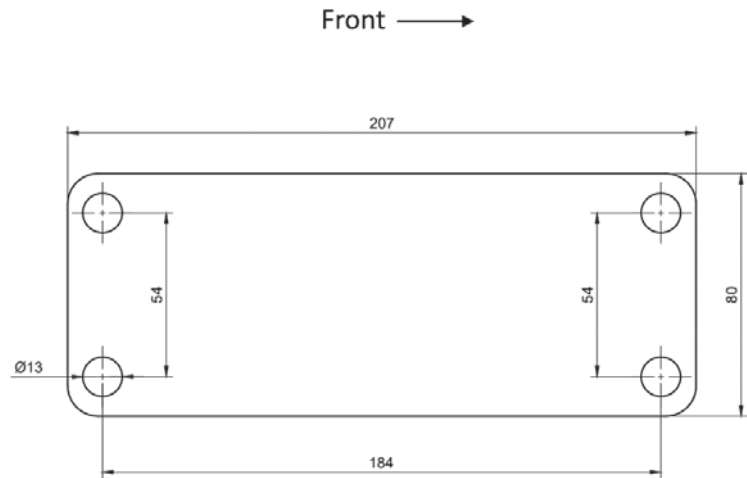

Non-Standard 4 Hole

2.5 Tonne (OZHITCH)

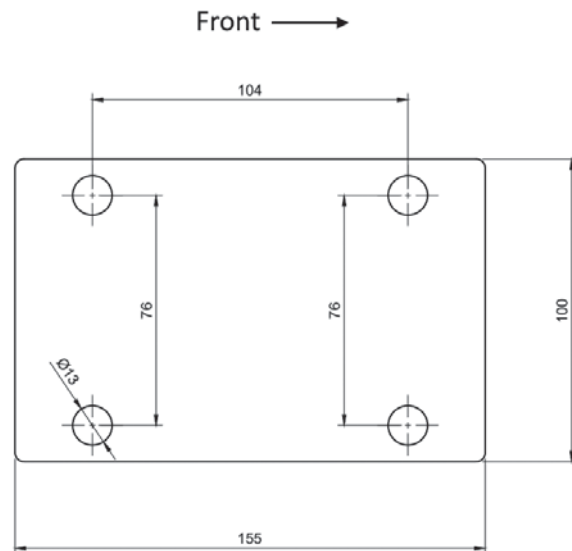

Standard 6 Hole

OZHITCH 3.5 Tonne/2.0 Override
(6 hole versions)

